

Material:
Housing: PC UL94V-0
Contacts: Phosphor Bronze, Tin plated, T=0.8mm
PCB welding point retention: 1LB Min.
Life: 750 cycles Min.

Electrical Characteristics:
Rated Current: 1.5 AMP
Rated Voltage: 125V AC
Contact Resistance: 30mΩ Max.
Insulator Resistance: 500MΩ Min. at DC 500V
Withstanding Voltage: AC 1000V/1min
Operating Temperature: -45°C ~ +85°C

Order Information :
IDC-PCB-2: 4P = 2 Pair IDC Connector
IDC-PCB-4: 8P = 4 Pair IDC Connector

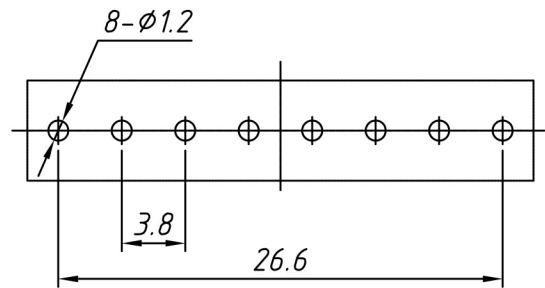

GENERAL TOLERANCE		ANGLE TOLERANCE		PROJECTION		Description:	
X.	±0.30	X.	±1°	UNITS	mm	Krone IDC Connector	
.X	±0.2	.X	±1°	SHEET SIZE	A4		
.XX	±0.15	.XX	±1°	KLS P/N:	Item code:		
Draw by: Date				KLS ELECTRONIC CO., LTD.			
Check by: Date							
SCALE		SHEET	OF				