

# 2.0 Pitch 2001 SERIES CONNECTOR



2.0 mm Pitch Wire-to-Board Connector



## Specifications

- ◇ Current rating: 2A AC/DC Max.
- ◇ Voltage Range: 100V AC,DC
- ◇ Withstand Voltage: 800V AC/Minute
- ◇ Contact Resistance: 10 mΩ Max. before environment test
- ◇ Insulation Resistance: 1000 MΩ Min.
- ◇ Temperature Range: -40° C to 85° C

## Reference

- ◇ Mates with 2002P, 2003P series Single-Row Header
- ◇ Use with 2005T series Crimp Terminal
- ◇ Certifications: UL, CSA, TUV
- ◇ Applicable wire gauge: AWG 24 - 28

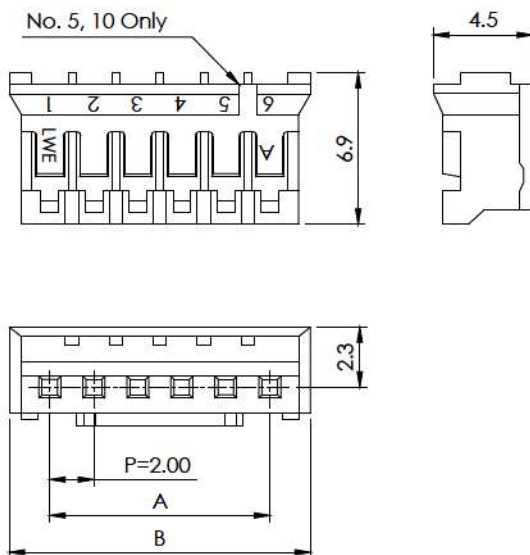

## 2001S Single-Row Plug Housing

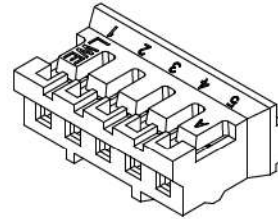

## Ordering Information

Circuits	Part No.	Dimension	
		A	B
2	2001S02 00	2.0	5.7
3	2001S03 00	4.0	7.7
4	2001S04 00	6.0	9.7
5	2001S05 00	8.0	11.7
6	2001S06 00	10.0	13.7
7	2001S07 00	12.0	15.7
8	2001S08 00	14.0	17.7
9	2001S09 00	16.0	19.7
10	2001S10 00	18.0	21.7
11	2001S11 00	20.0	23.7
12	2001S12 00	22.0	25.7
13	2001S13 00	24.0	27.7
14	2001S14 00	26.0	29.7
15	2001S15 00	28.0	31.7
16	2001S16 00	30.0	33.7

## Material

Part	Material / Finish
Housing	Nylon 66 94V-0, White (natural)

※ Color Identification: the following alphabet shall be put  
 ex. 2001S16 00- B  
 16... Circuit no., B... Black, R... Red, M... Green, E... Blue, W... Brown  
 Y... Yellow, P... pink, D... Orange, H... Gray

## Reference

- ◇ Use with 2001S series Plug Housing

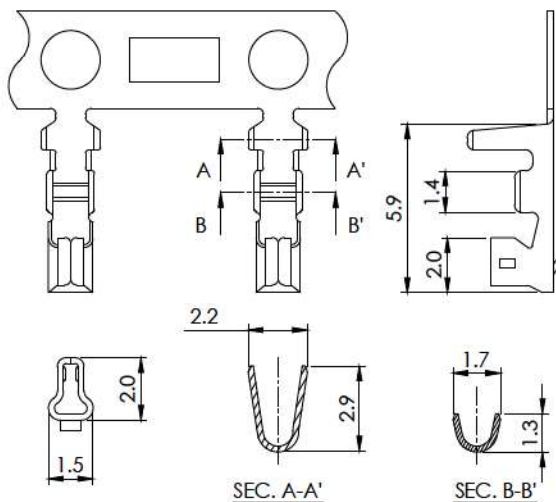

## 2005T Crimp Terminal

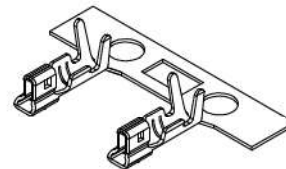

## Ordering Information

Part No.	Applicable Wire		
	AWG #	Insulation O.D. mm	Q'ty / Reel
2005T011R	24 - 28	1.6 Max.	10,000

## Material

Part No.	Material
2005T011R	Phosphor Bronze Tin-Plated

# 2.0 Pitch 2001 SERIES CONNECTOR



2.0 mm Pitch Wire-to-Board Connector

RoHS REACH LF HFA GWT

## Specifications

- ◇ Current rating: 2A AC/DC Max.
- ◇ Voltage Range: 100V AC,DC
- ◇ Withstand Voltage: 800V AC/Minute
- ◇ Contact Resistance: 10 mΩ Max. before environment test
- ◇ Insulation Resistance: 1000 MΩ Min.
- ◇ Temperature Range: -40° C to 85° C

## Reference

- ◇ Mates with 2001S series Single-Row Plug Housing
- ◇ Certifications: UL, CSA, TUV
- ◇ GWT 750° C rated product is available

2002P, 2003P DIP Header

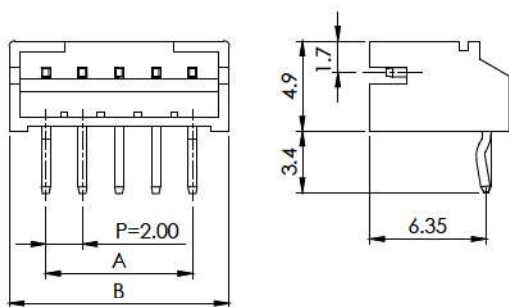
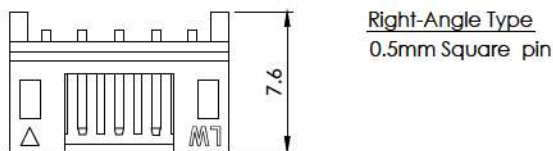
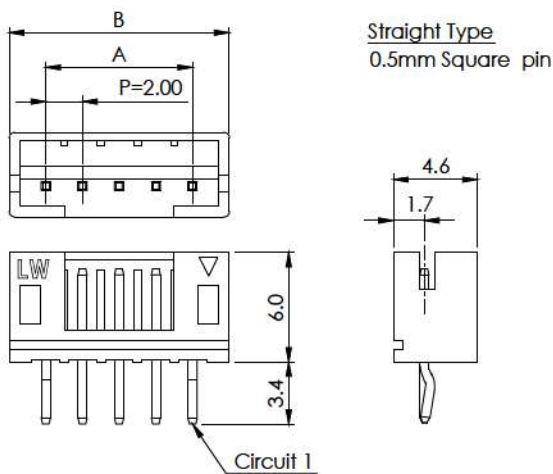
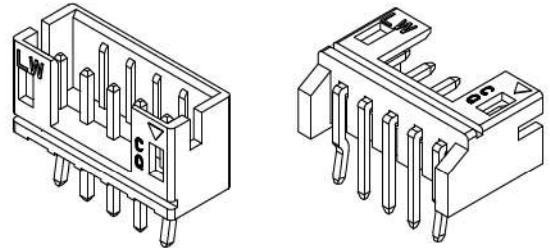

## Ordering Information

Circuits	Part No.		Dimension	
	Straight	Right-Angle	A	B
2	2002P02 00T	2003P02 00T	2.0	6.0
3	2002P03 00T	2003P03 00T	4.0	8.0
4	2002P04 00T	2003P04 00T	6.0	10.0
5	2002P05 00T	2003P05 00T	8.0	12.0
6	2002P06 00T	2003P06 00T	10.0	14.0
7	2002P07 00T	2003P07 00T	12.0	16.0
8	2002P08 00T	2003P08 00T	14.0	18.0
9	2002P09 00T	2003P09 00T	16.0	20.0
10	2002P10 00T	2003P10 00T	18.0	22.0
11	2002P11 00T	2003P11 00T	20.0	24.0
12	2002P12 00T	2003P12 00T	22.0	26.0
13	2002P13 00T	2003P14 00T	24.0	28.0
14	2002P14 00T	2003P14 00T	26.0	30.0
15	2002P15 00T	2003P15 00T	28.0	32.0
16	2002P16 00T	2003P16 00T	30.0	34.0

## Material

Part	Material / Finish
Base	Nylon 66 94V-0, White (natural)
Contact	Brass, Re-flow tin-plated

※ Color Identification: the following alphabet shall be put  
 ex. 2002P16 00T - B  
 ex. 2003P16 00T - B  
 16... Circuit no., B... Black, R... Red, M... Green, E... Blue, W... Brown  
 Y... Yellow, P... pink, D... Orange, H... Gray

## P.C. Board Layout / Assembly Layout

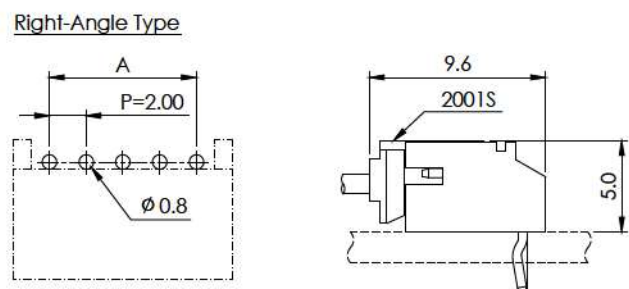
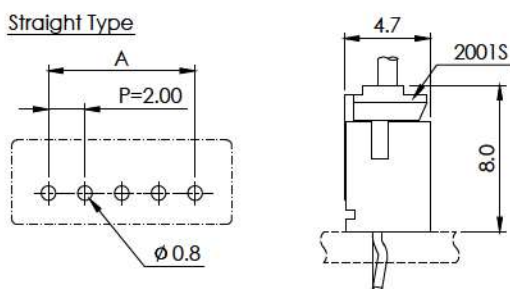

# 2.0 Pitch 2001 SERIES CONNECTOR



2.0 mm Pitch Wire-to-Board Connector

RoHS REACH LF HFA GWT

## 2002P DIP Header (Type H)

### Specifications

- ◇ Current rating: 2A AC/DC Max.
- ◇ Voltage Range: 100V AC,DC
- ◇ Withstand Voltage: 800V AC/Minute
- ◇ Contact Resistance: 10 mΩ Max. before environment test
- ◇ Insulation Resistance: 1000 MΩ Min.
- ◇ Temperature Range: -40° C to 85° C

### Reference

- ◇ Mates with 2001S series Single-Row Plug Housing
- ◇ Certifications: refer to 2001S series
- ◇ GWT 750° C rated product is available

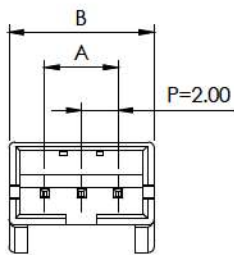
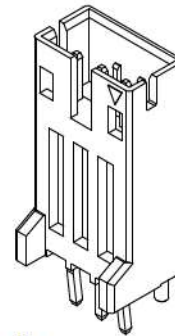

Straight Type  
0.5mm Square pin

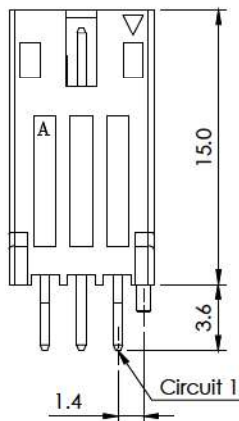

### Ordering Information

Circuits	Part No.	Dimension	
		A	B
2	2002P02 H0T	2.0	5.9
3	2002P03 H0T	4.0	7.9

### Material

Part	Material / Finish
Base	Nylon 66 94V-0, White (natural)
Contact	Brass, Tin-plated

※ Color Identification: the following alphabet shall be put

ex. 2003P03 H0T - B

03... Circuit no., B... Black, R... Red, M... Green, E... Blue, W... Brown  
Y... Yellow, P... pink, D... Orange, H... Gray

## P.C. Board Layout / Assembly Layout

### Straight Type

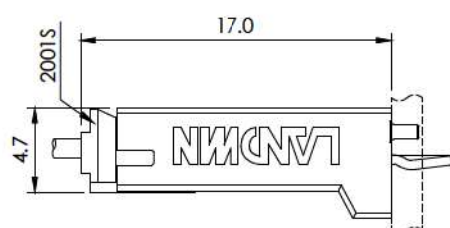
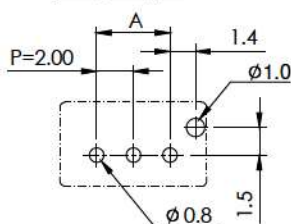



# 2.0 Pitch 2001 SERIES CONNECTOR



2.0 mm Pitch Wire-to-Board Connector

RoHS REACH LF HFA GWT

## Specifications

- ◇ Current rating: 2A AC/DC Max.
- ◇ Voltage Range: 100V AC,DC
- ◇ Withstand Voltage: 800V AC/Minute
- ◇ Contact Resistance: 10 mΩ Max. before environment test
- ◇ Insulation Resistance: 1000 MΩ Min.
- ◇ Temperature Range: -40° C to 85° C

## Reference

- ◇ Mates with 2001S series Single-Row Plug Housing
- ◇ Certifications: refer to 2001S series
- ◇ GWT 850° C rated product is available

2002P, 2003P DIP Header

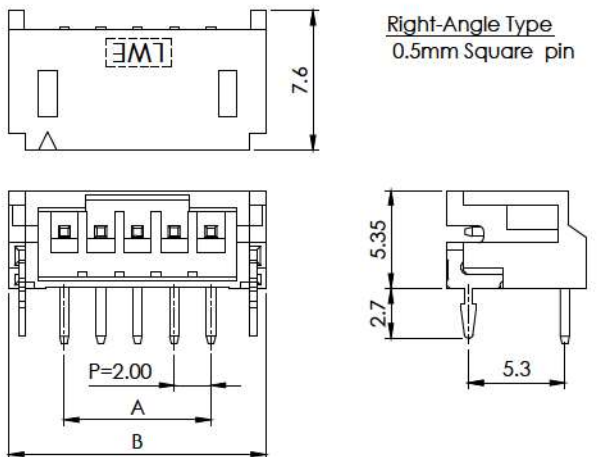
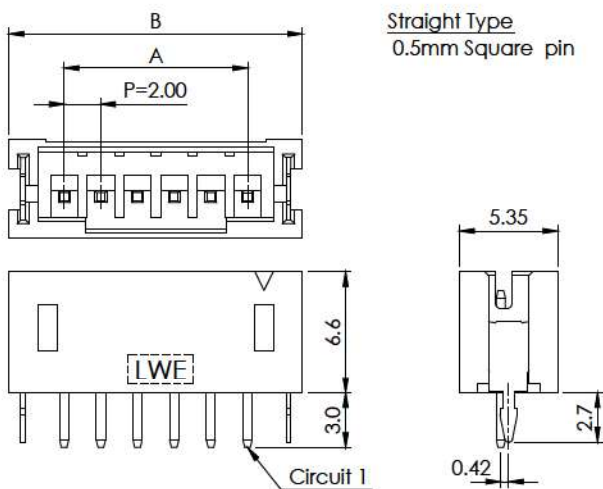
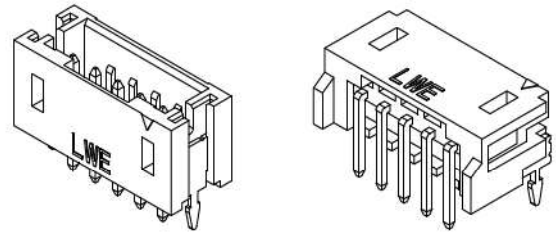

## Ordering Information REFLOW SOLDER SERIES

Circuits	Part No.		Dimension	
	Straight	Right-Angle	A	B
2	2002P02 B4T	2003P02 B4T	2.0	8.0
3	2002P03 B4T	2003P03 B4T	4.0	10.0
4	2002P04 B4T	2003P04 B4T	6.0	12.0
5	2002P05 B4T	2003P05 B4T	8.0	14.0
6	2002P06 B4T	2003P06 B4T	10.0	16.0
7	2002P07 B4T	2003P07 B4T	12.0	18.0
8	2002P08 B4T	2003P08 B4T	14.0	20.0
9	2002P09 B4T	2003P09 B4T	16.0	22.0
10	2002P10 B4T	2003P10 B4T	18.0	24.0
11	2002P11 B4T	2003P11 B4T	20.0	26.0
12	2002P11 B4T	2003P12 B4T	22.0	28.0
13	2002P13 B4T	2003P13 B4T	24.0	30.0
14	2002P14 B4T	2003P14 B4T	26.0	32.0
15	2002P15 B4T	2003P15 B4T	28.0	34.0

## Material

Part	Material / Finish
Base	HIGH HDT Nylon-GF 94V-0, Ivory color
Contact	Brass, Re-flow tin-plated
Metal Peg	Brass, Matte tin-plated

※ Color Identification: the following alphabet shall be put  
 ex. 2002P16 B4T - B  
 ex. 2003P16 B4T - B  
 16... Circuit no., B... Black, R... Red, E... Blue

※ P/N for Halogen-Free replacement:  
 ex. 2002P16 B4T - S NH  
 ex. 2003P16 B4T - S NH  
 -S... Ivory (natural color), NH... Halogen-Free

## P.C. Board Layout / Assembly Layout

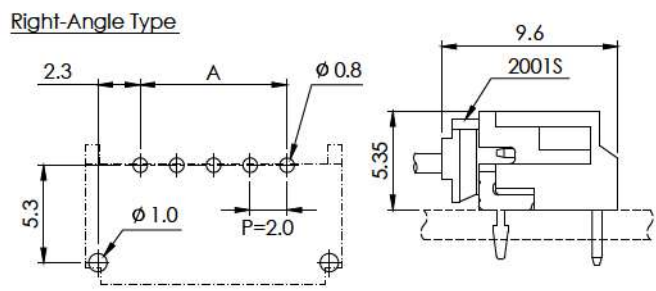
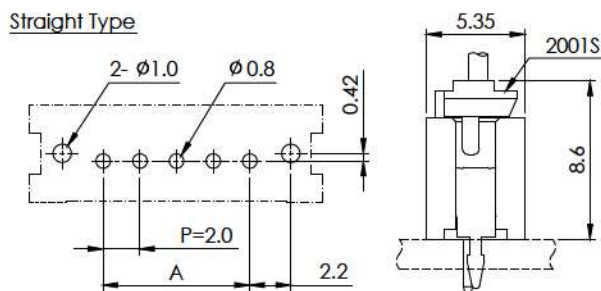

# 2.0 Pitch 2001 SERIES CONNECTOR



2.0 mm Pitch Wire-to-Board Connector

RoHS REACH LF HFA GWT

## Specifications

- ◇ Current rating: 2A AC/DC Max.
- ◇ Voltage Range: 100V AC,DC
- ◇ Withstand Voltage: 800V AC/Minute
- ◇ Contact Resistance: 10 mΩ Max. before environment test
- ◇ Insulation Resistance: 1000 MΩ Min.
- ◇ Temperature Range: -40° C to 85° C

## Reference

- ◇ Mates with 2001S series Single-Row Plug Housing
- ◇ Certifications: refer to 2001S series
- ◇ GWT 850° C rated product is available

## 2002P, 2003P SMT Header

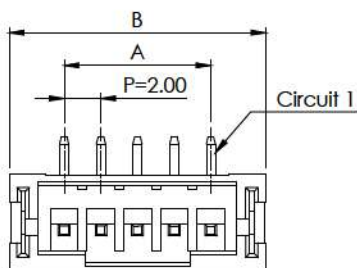
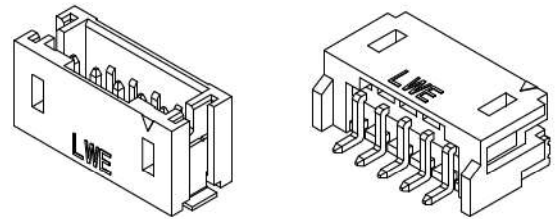

**Straight Type**  
0.5mm Square pin

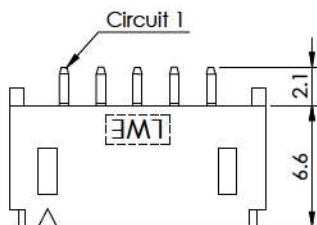
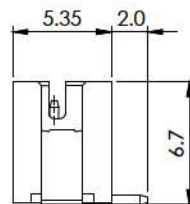
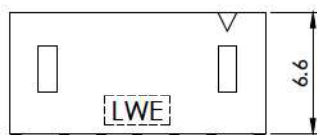

**Right-Angle Type**  
0.5mm Square pin

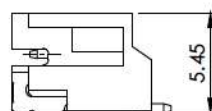
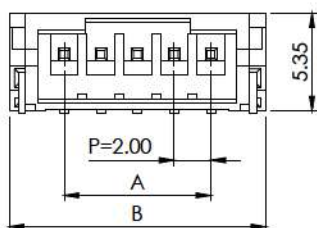

## Ordering Information REFLOW SOLDER SERIES

Circuits	Part No.		Dimension	
	Straight	Right-Angle	A	B
2	2002P02 S0T	2003P02 S0T	2.0	8.0
3	2002P03 S0T	2003P03 S0T	4.0	10.0
4	2002P04 S0T	2003P04 S0T	6.0	12.0
5	2002P05 S0T	2003P05 S0T	8.0	14.0
6	2002P06 S0T	2003P06 S0T	10.0	16.0
7	2002P07 S0T	2003P07 S0T	12.0	18.0
8	2002P08 S0T	2003P08 S0T	14.0	20.0
9	2002P09 S0T	2003P09 S0T	16.0	22.0
10	2002P10 S0T	2003P10 S0T	18.0	24.0
11	2002P11 S0T	2003P11 S0T	20.0	26.0
12	2002P12 S0T	2003P12 S0T	22.0	28.0
13	2002P13 S0T	2003P13 S0T	24.0	30.0
14	2002P14 S0T	2003P14 S0T	26.0	32.0
15	2002P15 S0T	2003P15 S0T	28.0	34.0

## Material

Part	Material / Finish
Base	HIGH HDT Nylon-GF 94V-0, Ivory color
Contact	Brass, Re-flow tin-plated
Peg	Brass, Matte tin-plated

※ Color Identification: the following alphabet shall be put  
ex. 2002P16 S0T - B  
ex. 2003P16 S0T - B  
16... Circuit no., B... Black, R... Red , E... Blue

※ P/N for Halogen-Free replacement:  
ex. 2002P16 S0T - S NH  
ex. 2003P16 S0T - S NH  
-S... Ivory (natural color)  
NH... Halogen-Free

※ SMT Embossed Tape Packing Information:  
Q' ty per 330 mm Dia. Panel: 700 PCS/Reel (2002P)  
Q' ty per 330 mm Dia. Panel: 900 PCS/Reel (2003P)

## P.C. Board Layout / Assembly Layout

