

# 2.5 Pitch 2508 SERIES CONNECTOR



2.5 mm Pitch Board-In Connector

RoHS REACH LF HFA GWT

## Specifications

- ◇ Current rating: 3A AC/DC Max. (AWG 22)
- ◇ Voltage Range: 250V AC,DC
- ◇ Withstand Voltage: 800V AC/Minute
- ◇ Contact Resistance: 10 mΩ Max. before environment test
- ◇ Insulation Resistance: 1000 MΩ Min.
- ◇ Temperature Range: -25° C to 85° C
- ◇ Applicable Wire Size: AWG 22 to AWG 28

## Reference

- ◇ Use with 2509T, 2519T series Board-In Crimp Terminal
- ◇ Certification: UL, CSA
- ◇ GWT 750° C rated product is available

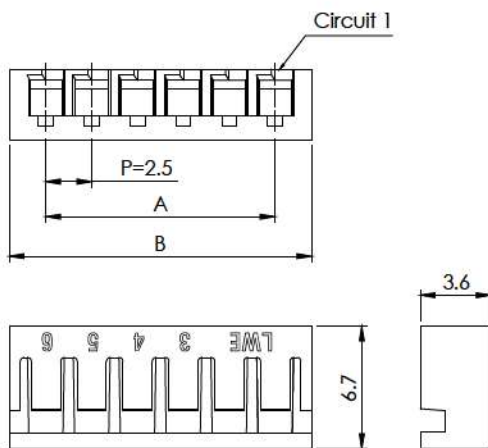

## 2508S Board-In Housing

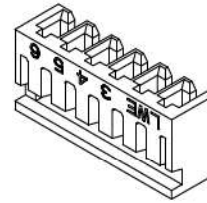

Straight Layout

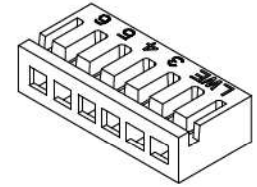

Right-angle Layout

## Ordering Information

Circuits	Part No.	Dimension	
		A	B
2	2508S0200	2.5	6.5
3	2508S0300	5.0	9.0
4	2508S0400	7.5	11.5
5	2508S0500	10.0	14.0
6	2508S0600	12.5	16.5
7	2508S0700	15.0	19.0
8	2508S0800	17.5	21.5
9	2508S0900	20.0	24.0
10	2508S1000	22.5	26.5
11	2508S1100	25.0	29.0
12	2508S1200	27.5	31.5
13	2508S1300	30.0	34.0
14	2508S1400	32.5	36.5
15	2508S1500	35.0	39.0
16	2508S1600	37.5	41.5

## Material

Part	Material / Finish
Housing	Nylon 66 94V-0, white (natural color)

2508S MATES WITH 2509T

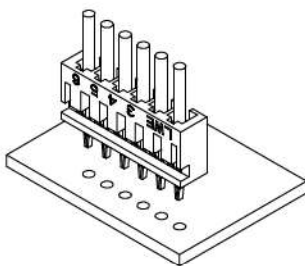

2508S MATES WITH 2519T

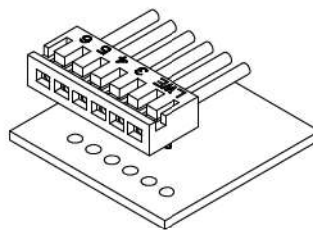

※ Color Identification: the following alphabet shall be put,  
ex. 2508S 06 0 0 - E  
06... Circuit no. E... Blue, R... Red Color,

## P.C. Board Layout / Assembly Layout

Straight Layout

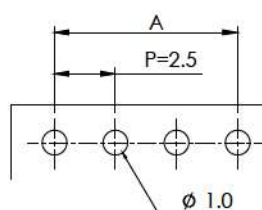

Right-angle Layout

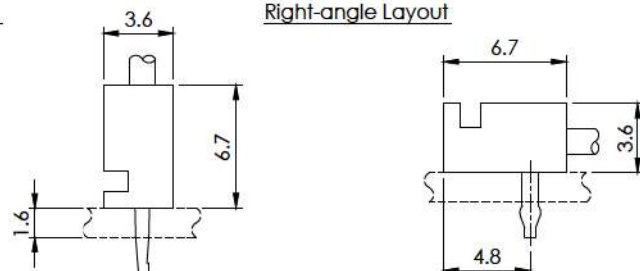

# 2.5 Pitch 2508 SERIES CONNECTOR



2.5 mm Pitch Board-In Connector



## ■ Specifications

- ◇ Current rating: 3A AC/DC (AWG 22)
- ◇ Voltage Range: 250V AC,DC
- ◇ Contact Resistance: 10 mΩ Max. before environment test
- ◇ Temperature Range: -25° C to 85° C

## ■ Reference

- ◇ Use with 2508S series Board-In Housing

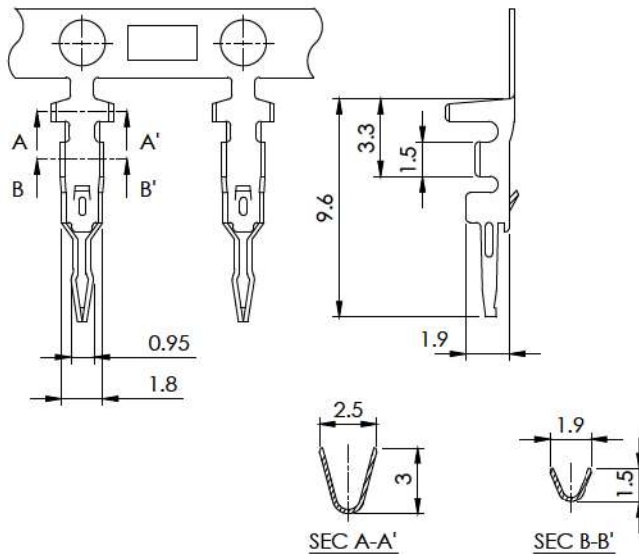

## 2509T Board-In Crimp Terminal



### Ordering Information

Part No.	Applicable Wire		Q'ty / Reel
	AWG #	Insulation O.D. mm	
2509T022R	22 - 28	1.8 Max.	10,000

### Material

Part No.	Material / Finish
2509T022R	Brass, Tin-plated

## ■ Specifications

- ◇ Current rating: 3A AC/DC (AWG 22)
- ◇ Voltage Range: 250V AC,DC
- ◇ Contact Resistance: 10 mΩ Max. before environment test
- ◇ Temperature Range: -25° C to 85° C

## ■ Reference

- ◇ Use with 2508S series Board-In Housing

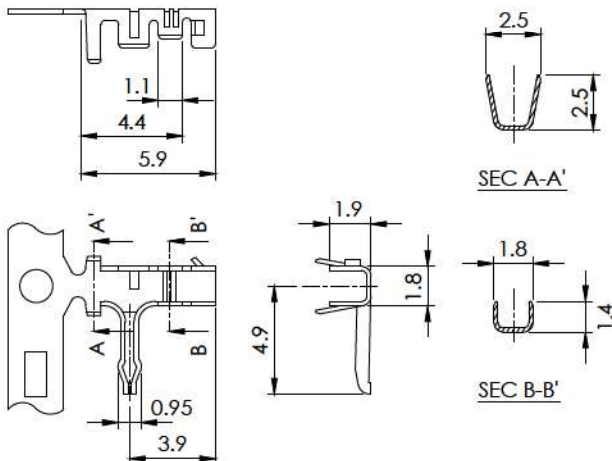

## 2519T Board-In Crimp Terminal

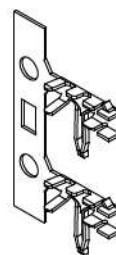

### Ordering Information

Part No.	Applicable Wire		Q'ty / Reel
	AWG #	Insulation O.D. mm	
2519T011R	22 - 28	1.8 Max.	10,000
2519T012R	22 - 28	1.8 Max.	10,000

### Material

Part No.	Material / Finish
2519T011R	Phosphor Bronze, Tin-plated
2519T012R	Brass, Tin-plated