

# 2.5 Pitch 2510 SERIES CONNECTOR



2.5 mm Pitch Wire-to-Board Connector



## Specifications

- ◇ Current rating: 3A AC/DC Max.
- ◇ Voltage Range: 250V AC,DC
- ◇ Withstand Voltage: 1000V AC/Minute
- ◇ Contact Resistance: 20 mΩ Max. before environment test
- ◇ Insulation Resistance: 1000 MΩ Min.
- ◇ Temperature Range: -40° C to 105° C

## Reference

- ◇ Mates with 2511P, 2512P series DIP Header
- ◇ Mates with 2640M Type-C series Receptacle Housing
- ◇ Use with 2543T series Crimp Terminal
- ◇ Certification: UL, CSA
- ◇ GWT 850° C rated product is available
- ◇ Applicable wire gauge: AWG 22 - 28

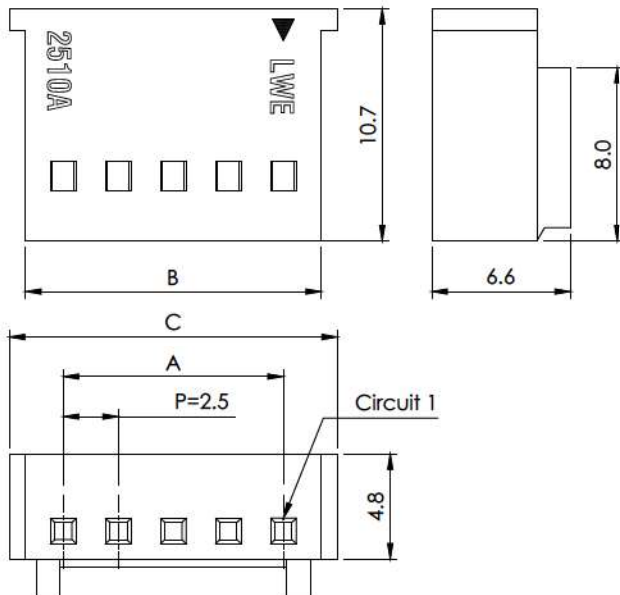

## 2510S Plug Housing (Type A)

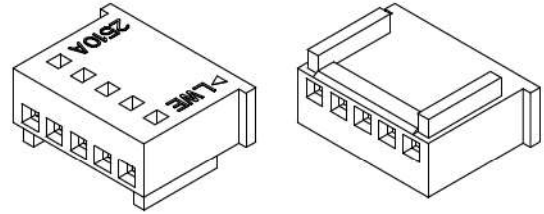

## Ordering Information

Circuits	Part No.	Dimension		
		A	B	C
2	2510S02A0	2.5	6.0	7.5
3	2510S03A0	5.0	8.5	10.0
4	2510S04A0	7.5	11.0	12.5
5	2510S05A0	10.0	13.5	15.0
6	2510S06A0	12.5	16.0	17.5
7	2510S07A0	15.0	18.5	20.0
8	2510S08A0	17.5	21.0	22.5
9	2510S09A0	20.0	23.5	25.0
10	2510S10A0	22.5	26.0	27.5
11	2510S11A0	25.0	28.5	30.0
12	2510S12A0	27.5	31.0	32.5
13	2510S13A0	30.0	33.5	35.0
14	2510S14A0	32.5	36.0	37.5
15	2510S15A0	35.0	38.5	40.0

## Material

Part	Material
Housing	Nylon 66 94V-0, Light ivory color

※ Color Identification: the following alphabet shall be added,  
 ex. 2510S 12 A0 - B  
 12... Circuit no.  
 B... Black, E... Blue, R... Red color

## Reference

- ◇ Use with 2510S Type-A, 2540S, 2640S Type-A series Plug Housing

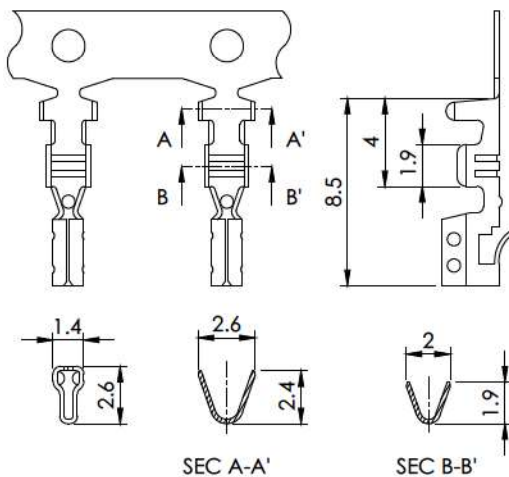

## 2543T Crimp Terminal

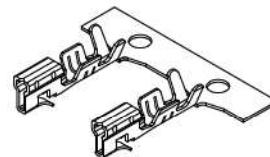

## Ordering Information

Part No.	Applicable Wire		Q'ty / Reel
	AWG #	Insulation O.D. mm	
2543T011R	22 - 28	1.9 Max.	10,000

## Material

Part No.	Material	Remark
2543T011R	Phosphor Bronze Tin-Plated	

# 2.5 Pitch 2600 SERIES CONNECTOR



2.5 mm Pitch Wire-to-Board Connector



## Specifications

- ◇ Current rating: 3A AC/DC Max.
- ◇ Voltage Range: 250V AC,DC
- ◇ Withstand Voltage: 1000V AC/Minute
- ◇ Contact Resistance: 20 mΩ Max. before environment test
- ◇ Insulation Resistance: 1000 MΩ Min.
- ◇ Temperature Range: -40° C to 105° C

## Reference

- ◇ Mates with 2511P, 2512P series DIP Header
- ◇ Use with 2563T series Crimp Terminal
- ◇ Certification: UL, CSA
- ◇ GWT 850° C rated product is available
- ◇ Applicable wire gauge: AWG 22 - 28

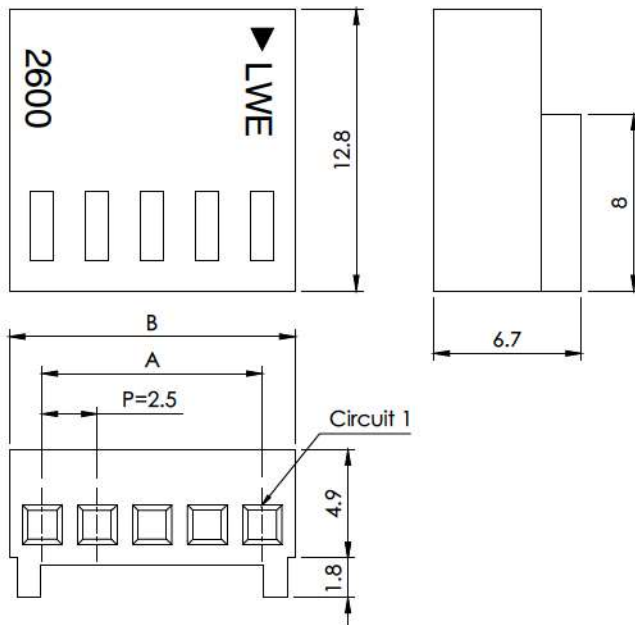

## 2600S Plug Housing

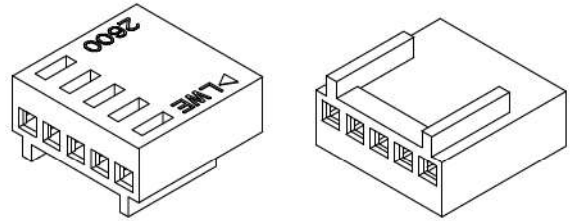

## Ordering Information

Circuits	Part No.	Dimension	
		A	B
2	2600S0200	2.5	5.5
3	2600S0300	5.0	8.0
4	2600S0400	7.5	10.5
5	2600S0500	10.0	13.0
6	2600S0600	12.5	15.5
7	2600S0700	15.0	18.0
8	2600S0800	17.5	20.5
9	2600S0900	20.0	23.0
10	2600S1000	22.5	25.5
11	2600S1100	25.0	28.0
12	2600S1200	27.5	30.5
13	2600S1300	30.0	33.0
14	2600S1400	32.5	35.5
15	2600S1500	35.0	38.0

## Material

Part	Material
Housing	Nylon 66 94V-0, Light ivory color

※ Color Identification: the following alphabet shall be added,  
 ex. 2600S 12 00 - B  
 12... Circuit no.  
 B... Black, E... Blue, R... Red color

## Reference

- ◇ Use with 2510S Type-1, 2560S, 2600S Series Plug Housing

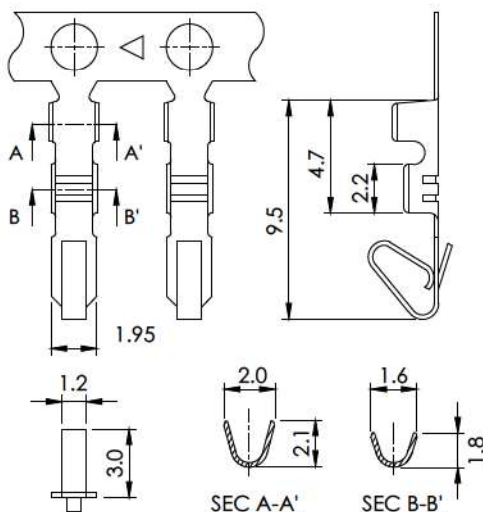

## 2563T Crimp Terminal

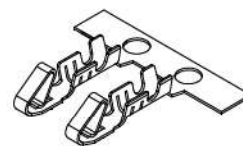

## Ordering Information

Part No.	Applicable Wire		
	AWG #	Insulation O.D. mm	Q'ty / Reel
2563T011R	22 - 28	1.9 Max.	10,000
2563T012R	22 - 28	1.9 Max.	10,000

## Material

Part No.	Material
2563T011R	Phosphor Bronze, Tin-Plated
2563T012R	Brass, Tin-Plated



# 2.5 Pitch 2510 SERIES CONNECTOR



2.5 mm Pitch Wire-to-Board Connector

RoHS REACH LF HFA GWT

## 2511P, 2512P DIP Header

### Specifications

- ◇ Current rating: 3A AC/DC Max.
- ◇ Voltage Range: 250V AC,DC
- ◇ Withstand Voltage: 1000V AC/Minute
- ◇ Contact Resistance: 20 mΩ Max. before environment test
- ◇ Insulation Resistance: 1000 MΩ Min.
- ◇ Temperature Range: -40° C to 105° C

### Reference

- ◇ Mates with 2510S Type-A, 2600S series Plug Housing
- ◇ Certification: Refer to 2510S series
- ◇ GWT 850° C rated product is available

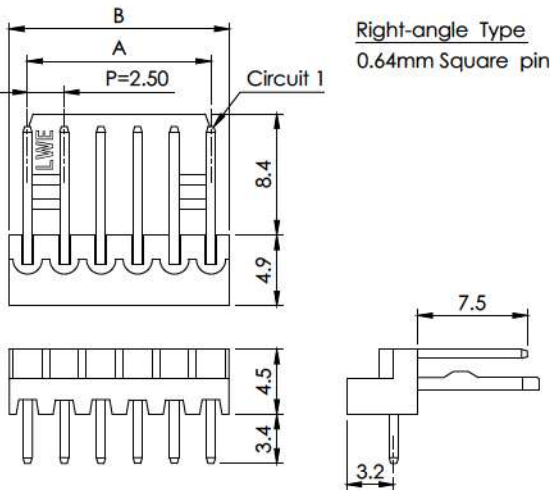
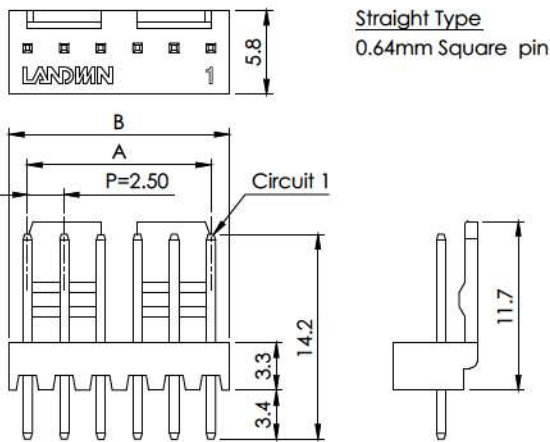
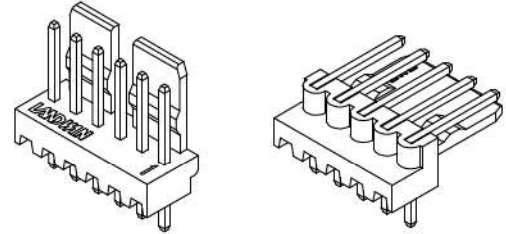

### Ordering Information

Circuits	Part No.		Dimension	
	Straight	Right-Angle	A	B
2	2511P0200T	2512P0200T	2.5	5.0
3	2511P0300T	2512P0300T	5.0	7.5
4	2511P0400T	2512P0400T	7.5	10.0
5	2511P0500T	2512P0500T	10.0	12.5
6	2511P0600T	2512P0600T	12.5	15.0
7	2511P0700T	2512P0700T	15.0	17.5
8	2511P0800T	2512P0800T	17.5	20.0
9	2511P0900T	2512P0900T	20.0	22.5
10	2511P1000T	2512P1000T	22.5	25.0
11	2511P1100T	2512P1100T	25.0	27.5
12	2511P1200T	2512P1200T	27.5	30.0
13	2511P1300T	2512P1300T	30.0	32.5
14	2511P1400T	2512P1400T	32.5	35.0
15	2511P1500T	2512P1500T	35.0	37.5

### Material

Part	Material
Base	Nylon 66 94V-0, Light ivory color
Contact	Brass, Tin-plated

※ Color Identification: the following alphabet shall be added,  
 ex. 2511P 12 00 T - B  
 ex. 2512P 12 00 T - B  
 12... Circuit no.  
 T... Tin-plated, V... Matte tin-plated  
 B... Black, E... Blue, R... Red color

### P.C. Board Layout / Assembly Layout

#### Straight Type

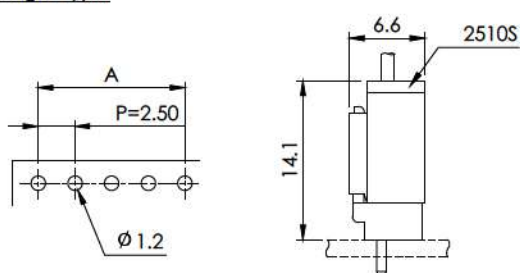

#### Right-angle Type

