

# 3.0 Pitch 3000 SERIES CONNECTOR



3.0 mm Pitch Wire-to-Board Connector



## Specifications

- ◇ Current rating: 5A AC/DC Max.
- ◇ Voltage Range: 250V AC,DC
- ◇ Withstand Voltage: 1500V AC/Minute
- ◇ Contact Resistance: 10 mΩ MAX. before environment test
- ◇ Insulation Resistance: 1000 MΩ Min.
- ◇ Temperature Range: -40° C to 105° C

## Reference

- ◇ Mates with 3000F series Single-row Plug Housing
- ◇ Certification: UL, CSA, TUV
- ◇ GWT 850° C rated product is available

3001P, 3002P Single-Row DIP Header  
(Type-1) High Temperature

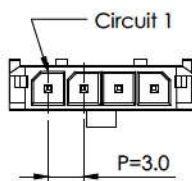
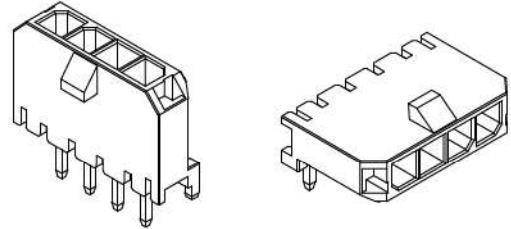

Straight Type  
0.64 Square Pin

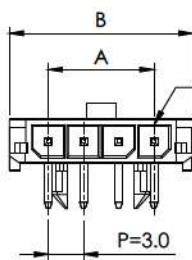
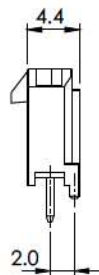
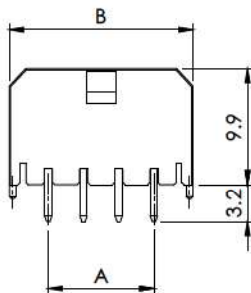

Right-angle Type  
0.64 Square Pin

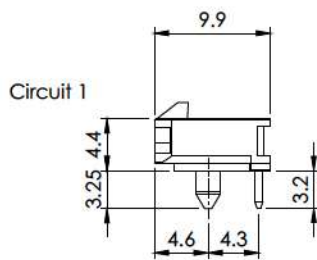

## Ordering Information

Circuits	Part No.		Dimension	
	Straight	Right Angle	A	B
2	3001P02 19V	3002P02 19V	3.00	9.7
3	3001P03 19V	3002P03 19V	6.00	12.7
4	3001P04 19V	3002P04 19V	9.00	15.7
5	3001P05 19V	3002P05 19V	12.00	18.7
6	3001P06 19V	3002P06 19V	15.00	21.7
7	3001P07 19V	3002P07 19V	18.00	24.7
8	3001P08 19V	3002P08 19V	21.00	27.7
9	3001P09 19V	3002P09 19V	24.00	30.7
10	3001P10 19V	3002P10 19V	27.00	33.7
11	3001P11 19V	3002P11 19V	30.00	36.7
12	3001P12 19V	3002P12 19V	33.00	39.7

## Material

Part	Material / Finish
Base	High HDT Nylon-GF 94V-0, black color
Contact	Brass, Matte tin-plated

### ※ PART NUMBER ASSIGNMENT:

ex. 3001P XX 1 9 X ( Straight Type )

ex. 3002P XX 1 9 X ( Right-angle Type )

XX... Circuit Nos (PIN Numbers)

X... Plating Selection: 1... Gold flash, V... Matte Tin

### ※ Color Identification: the following alphabet shall be put,

ex. 3001P 06 1 9 X - R

ex. 3002P 06 1 9 X - E

06... Circuit no. R... red, E... blue color

### ※ P/N for Halogen-Free replacement:

ex. 3001P 10 1 9 X - B NH

ex. 3002P 10 1 9 X - B NH

10... Circuit no. B... black color NH... Halogen-free

## P.C. Board Layout / Assembly Layout

Straight Type

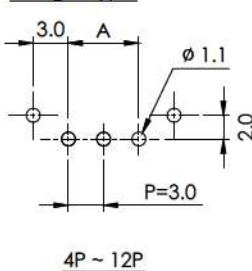

4P ~ 12P

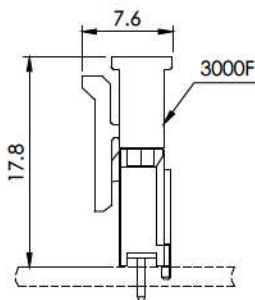

Right-angle Type

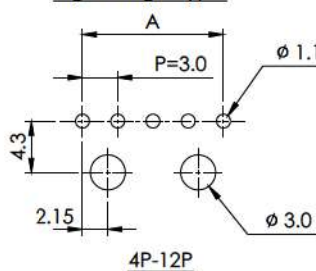

4P-12P

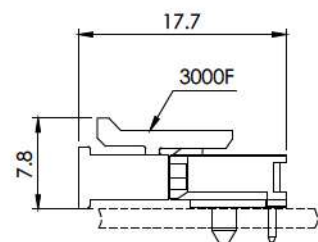

# 3.0 Pitch 3000 SERIES CONNECTOR



3.0 mm Pitch Wire-to-Board Connector



## Specifications

- ◇ Current rating: 5A AC/DC Max.
- ◇ Voltage Range: 250V AC,DC
- ◇ Withstand Voltage: 1500V AC/Minute
- ◇ Contact Resistance: 10 mΩ MAX. before environment test
- ◇ Insulation Resistance: 1000 MΩ Min.
- ◇ Temperature Range: -40° C to 105° C

## Reference

- ◇ Mates with 3000F series Single-row Plug Housing
- ◇ Certification: UL, CSA, TUV
- ◇ GWT 850° C rated product is available

## 3001P, 3002P Single-Row DIP Header (Type-3) High Temperature

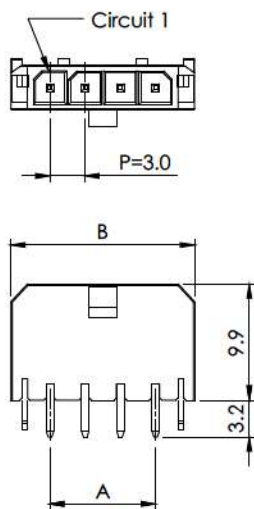
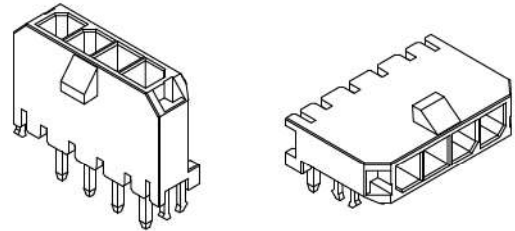

**Straight Type**  
0.64 Square contact

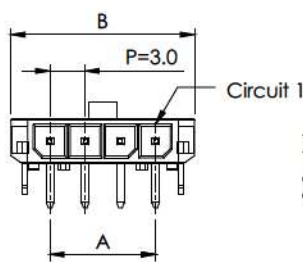
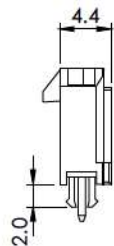

**Right-angle Type**  
0.64 Square contact

## Ordering Information HEAT SOLDER SERIES

Circuits	Part No.		Dimension	
	Straight	Right Angle	A	B
2	3001P02 39V	3002P02 39V	3.00	9.7
3	3001P03 39V	3002P03 39V	6.00	12.7
4	3001P04 39V	3002P04 39V	9.00	15.7
5	3001P05 39V	3002P05 39V	12.00	18.7
6	3001P06 39V	3002P06 39V	15.00	21.7
7	3001P07 39V	3002P07 39V	18.00	24.7
8	3001P08 39V	3002P08 39V	21.00	27.7
9	3001P09 39V	3002P09 39V	24.00	30.7
10	3001P10 39V	3002P10 39V	27.00	33.7
11	3001P11 39V	3002P11 39V	30.00	36.7
12	3001P12 39V	3002P12 39V	33.00	39.7

## Material

Part	Material / Finish
Base	High HDT Nylon-GF 94V-0, black color
Contact	Brass, Matte tin-plated
Metal peg	Brass, Matte tin-plated

### ※ PART NUMBER ASSIGNMENT:

ex. 3001P XX 3 9 X ( Straight Type )

ex. 3002P XX 3 9 X ( Right-angle Type )

XX... Circuit Nos (PIN Numbers),

X... Plating Selection: 1... Gold flash, V... Matte Tin

### ※ Color Identification: the following alphabet shall be put,

ex. 3001P 06 3 9 X - R

ex. 3002P 06 3 9 X - E

06... Circuit no. R... red, E... blue color

### ※ P/N for Halogen-Free replacement:

ex. 3001P 10 3 9 X - B NH

ex. 3002P 10 3 9 X - B NH

10... Circuit no. B... black color NH... Halogen-free

## P.C. Board Layout / Assembly Layout

### Straight Type

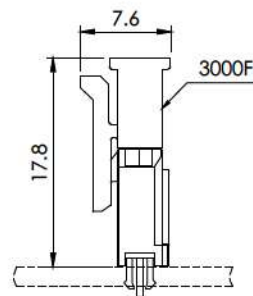
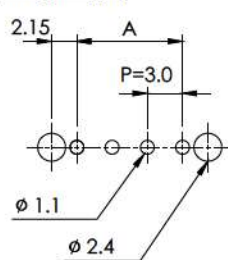

### Right -angle Type

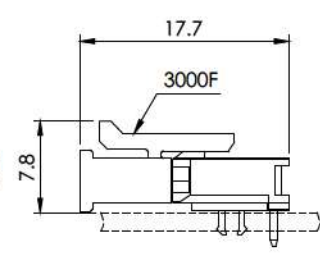
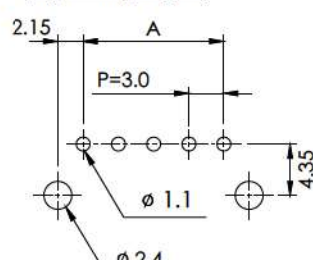

# 3.0 Pitch 3000 SERIES CONNECTOR



3.0 mm Pitch Wire-to-Board Connector

RoHS REACH LF HFA GWT

## Specifications

- ◇ Current rating: 5A AC/DC Max.
- ◇ Voltage Range: 250V AC,DC
- ◇ Withstand Voltage: 1500V AC/Minute
- ◇ Contact Resistance: 10 mΩ Max. before environment test
- ◇ Insulation Resistance: 1000 MΩ Min.
- ◇ Temperature Range: -40° C to 105° C

## Reference

- ◇ Mates with 3000F series Single-row Plug Housing
- ◇ Certification: UL, CSA, TUV
- ◇ GWT 850° C rated product is available

## 3001P, 3002P Single-Row SMT Header (Type-5) High Temperature

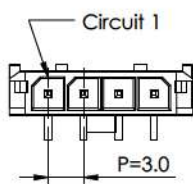
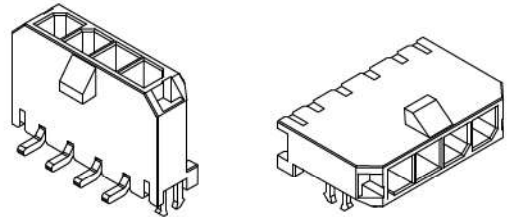

**Straight Type**  
0.64 Square contact

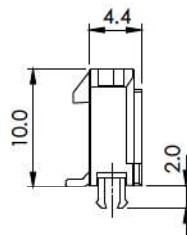
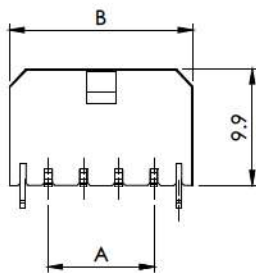

## Ordering Information REFLOW SOLDERING SERIES

Circuits	Part No.		Dimension	
	Straight	Right Angle	A	B
2	3001P02 59V	3002P02 59V	3.00	9.7
3	3001P03 59V	3002P03 59V	6.00	12.7
4	3001P04 59V	3002P04 59V	9.00	15.7
5	3001P05 59V	3002P05 59V	12.00	18.7
6	3001P06 59V	3002P06 59V	15.00	21.7
7	3001P07 59V	3002P07 59V	18.00	24.7
8	3001P08 59V	3002P08 59V	21.00	27.7
9	3001P09 59V	3002P09 59V	24.00	30.7
10	3001P10 59V	3002P10 59V	27.00	33.7
11	3001P11 59V	3002P11 59V	30.00	36.7
12	3001P12 59V	3002P12 59V	33.00	39.7

## Material

Part	Material / Finish
Base	High HDT Nylon-GF 94V-0, black color
Contact	Brass, Matte tin-plated
Metal peg	Brass, Matte tin-plated

### ※ PART NUMBER ASSIGNMENT:

- ex. 3001P XX 5 9 X (Straight Type)
- ex. 3002P XX 5 9 X (Right-angle Type)

XX... Circuit Nos (PIN Numbers),  
X... Plating Selection: 1... Gold flash, V... Matte Tin

### ※ Color Identification: the following alphabet shall be put,

- ex. 3001P 06 5 9 X - R
- ex. 3002P 06 5 9 X - E
- 06... Circuit no. R... red, E... blue color

### ※ P/N for Halogen-Free replacement:

- ex. 3001P 10 5 9 X - B NH
- ex. 3002P 10 5 9 X - B NH
- 10... Circuit no. B... black color NH... Halogen-free

**Right-angle Type**  
0.64 Square contact

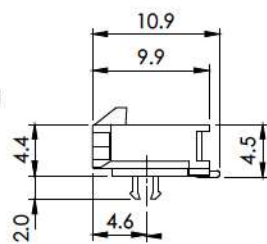
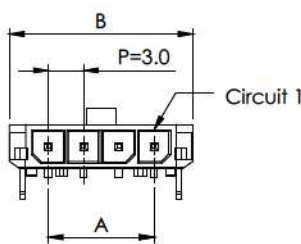

## P.C. Board Layout / Assembly Layout

**Straight Type**

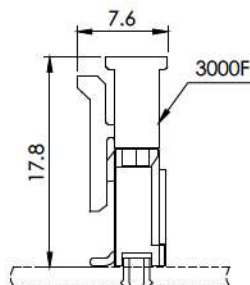
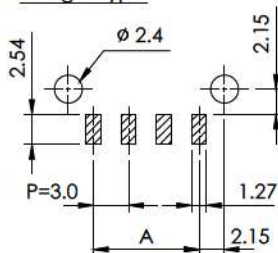

**Right-angle Type**

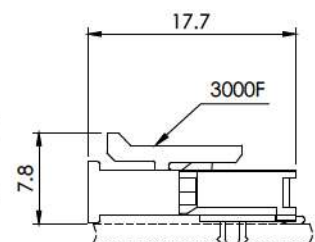
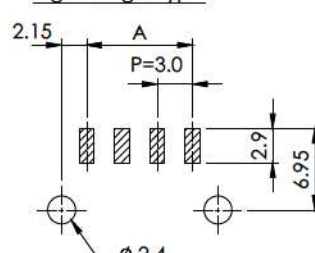

# 3.0 Pitch 3000 SERIES CONNECTOR



3.0 mm Pitch Wire-to-Board Connector

RoHS REACH LF HFA GWT

## Specifications

- ◇ Current rating: 5A AC/DC Max.
- ◇ Voltage Range: 250V AC,DC
- ◇ Withstand Voltage: 1500V AC/Minute
- ◇ Contact Resistance: 10 mΩ Max. before environment test
- ◇ Insulation Resistance: 1000 MΩ Min.
- ◇ Temperature Range: -40° C to 105° C

## Reference

- ◇ Mates with 3000F series Single-row Plug Housing
- ◇ Certification: UL, CSA, TUV
- ◇ GWT 850° C rated product is available

## 3001P, 3002P Single-Row SMT Header (Type-7) High Temperature

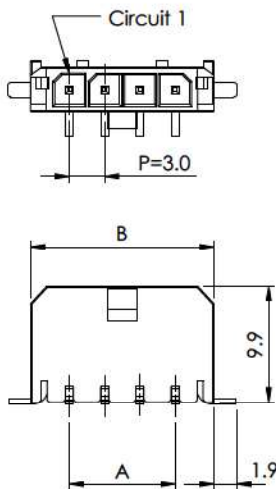
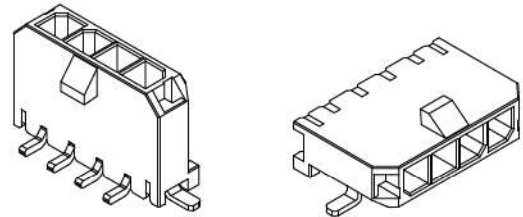

**Straight Type**  
0.64 Square contact

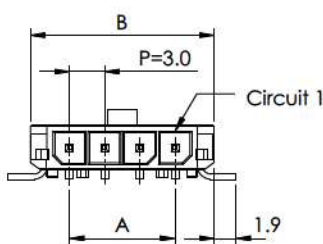
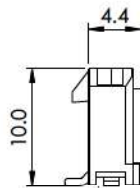

**Right-angle Type**  
0.64 Square contact

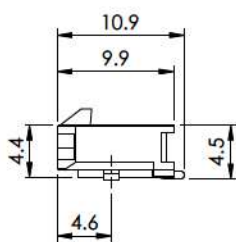

## Ordering Information

## REFLOW SOLDERING SERIES

Circuits	Part No.		Dimension		
	Straight	Right Angle	A	B	C
2	3001P02 79V	3002P02 79V	3.00	9.7	14.2
3	3001P03 79V	3002P03 79V	6.00	12.7	17.2
4	3001P04 79V	3002P04 79V	9.00	15.7	20.2
5	3001P05 79V	3002P05 79V	12.00	18.7	23.2
6	3001P06 79V	3002P06 79V	15.00	21.7	26.2
7	3001P07 79V	3002P07 79V	18.00	24.7	29.2
8	3001P08 79V	3002P08 79V	21.00	27.7	32.2
9	3001P09 79V	3002P09 79V	24.00	30.7	35.2
10	3001P10 79V	3002P10 79V	27.00	33.7	38.2
11	3001P11 79V	3002P11 79V	30.00	36.7	41.2
12	3001P12 79V	3002P12 79V	33.00	39.7	44.2

## Material

Part	Material / Finish
Base	High HDT Nylon-GF 94V-0, black color
Contact	Brass, Matte tin-plated
Metal peg	Brass, Matte tin-plated

### ※ PART NUMBER ASSIGNMENT:

- ex. 3001P XX 7 9 X ( Straight Type )
- ex. 3002P XX 7 9 X ( Right-angle Type )

XX... Circuit Nos (PIN Numbers)

X... Plating Selection: 1... Gold flash, V... Matte Tin

### ※ Color Identification: the following alphabet shall be put:

- ex. 3001P 06 7 9 X - R
- ex. 3002P 06 7 9 X - E
- 06... Circuit no. R... red, E... blue color

### ※ P/N for Halogen-Free replacement:

- ex. 3001P 10 7 9 X - B NH
- ex. 3002P 10 7 9 X - B NH
- 10... Circuit no. B... black color NH... Halogen-free

### ※ SMT Embossed Tape Packing Information:

Q' ty per 330 mm Dia. Panel: 250 pcs/Reel (3001P), 400 pcs/Reel (3002P)

## P.C. Board Layout / Assembly Layout

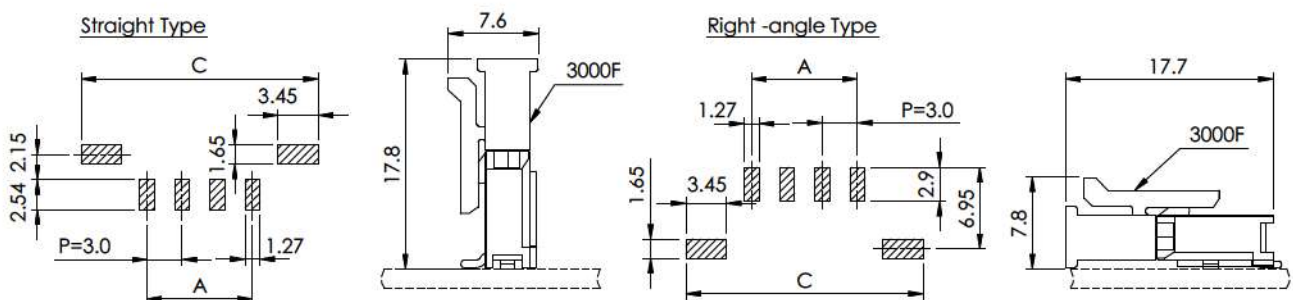

# 3.0 Pitch 3000 SERIES CONNECTOR



3.0 mm Pitch Wire-to-Board Connector



## Specifications

- ◇ Current rating: 5A AC/DC Max.
- ◇ Voltage Range: 250V AC,DC
- ◇ Withstand Voltage: 1500V AC/Minute
- ◇ Contact Resistance: 10 mΩ Max. before environment test
- ◇ Insulation Resistance: 1000 MΩ Min.
- ◇ Temperature Range: -40° C to 105° C

## Reference

- ◇ Mates with 3000F series dual-row Plug Housing
- ◇ Certification: UL, CSA, TUV
- ◇ GWT 850° C rated product is available

## 3001P, 3002P Dual-Row DIP Header (Type-2) High Temperature

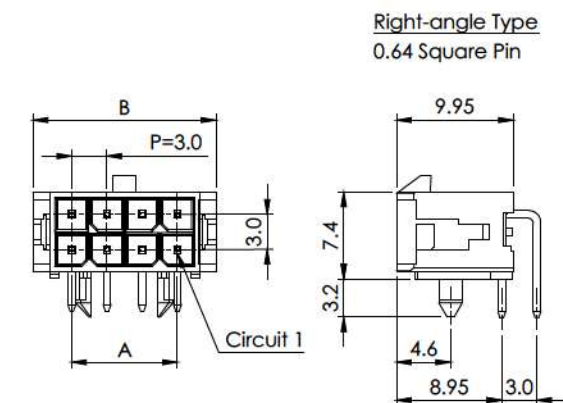
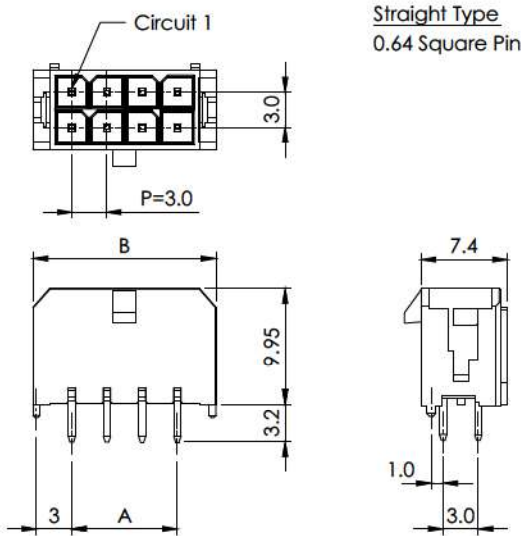
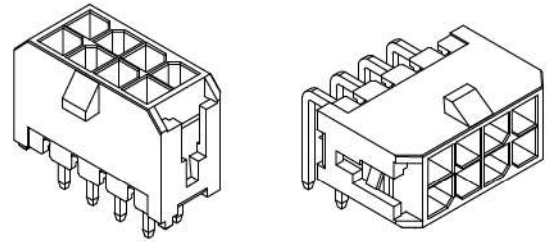

## Ordering Information HEAT SOLDER SERIES

Circuits	Part No.		Dimension	
	Straight	Right Angle	A	B
2	3001P02 29V	3002P02 29V	NA	6.7
4	3001P04 29V	3002P04 29V	3.00	9.7
6	3001P06 29V	3002P06 29V	6.00	12.7
8	3001P08 29V	3002P08 29V	9.00	15.7
10	3001P10 29V	3002P10 29V	12.00	18.7
12	3001P12 29V	3002P12 29V	15.00	21.7
14	3001P14 29V	3002P14 29V	18.00	24.7
16	3001P16 29V	3002P16 29V	21.00	27.7
18	3001P18 29V	3002P18 29V	24.00	30.7
20	3001P20 29V	3002P20 29V	27.00	33.7
22	3001P22 29V	3002P22 29V	30.00	36.7
24	3001P24 29V	3002P24 29V	33.00	39.7

## Material

Part	Material / Finish
Base	High HDT Nylon-GF 94V-0, black color
Contact	Brass, Matte tin-plated

### ※ PART NUMBER ASSIGNMENT:

ex. 3001P XX 2 9 X (Straight Type)

ex. 3002P XX 2 9 X (Right-angle Type)

XX... Circuit Nos (PIN Numbers)

X... Plating Selection: 1... Gold flash, V... Matte Tin

### ※ Color Identification: the following alphabet shall be put,

ex. 3001P 06 2 9 X - R

ex. 3002P 06 2 9 X - E

06... Circuit no. R... red, E... blue color

### ※ P/N for Halogen-Free replacement:

ex. 3001P 10 2 9 X - B NH

ex. 3002P 10 2 9 X - B NH

10... Circuit no. B... black color NH... Halogen-free

## P.C. Board Layout / Assembly Layout

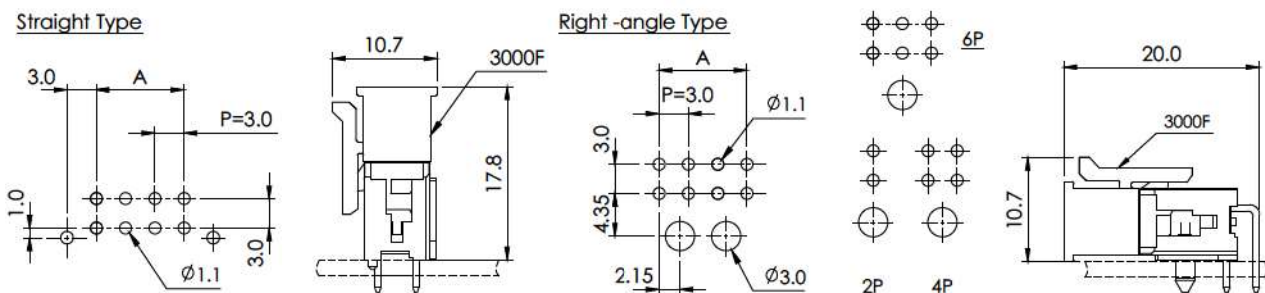

# 3.0 Pitch 3000 SERIES CONNECTOR



3.0 mm Pitch Wire-to-Board Connector



## Specifications

- ◇ Current rating: 5A AC/DC Max.
- ◇ Voltage Range: 250V AC,DC
- ◇ Withstand Voltage: 1500V AC/Minute
- ◇ Contact Resistance: 10 mΩ Max. before environment test
- ◇ Insulation Resistance: 1000 MΩ Min.
- ◇ Temperature Range: -40° C to 105° C

## Reference

- ◇ Mates with 3000F series dual-row Plug Housing
- ◇ Certification: UL, CSA, TUV
- ◇ GWT 850° C rated product is available

## 3001P, 3002P Dual-Row DIP Header (Type-4) High Temperature

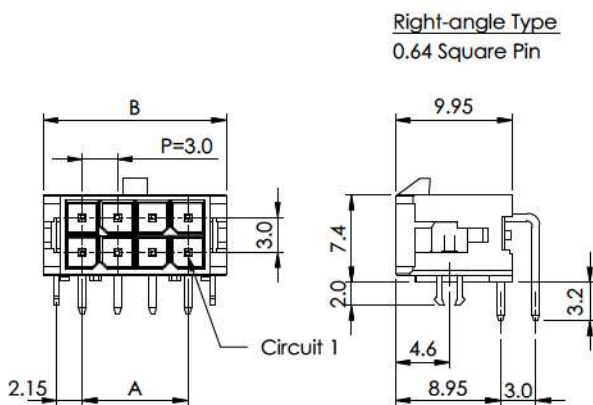
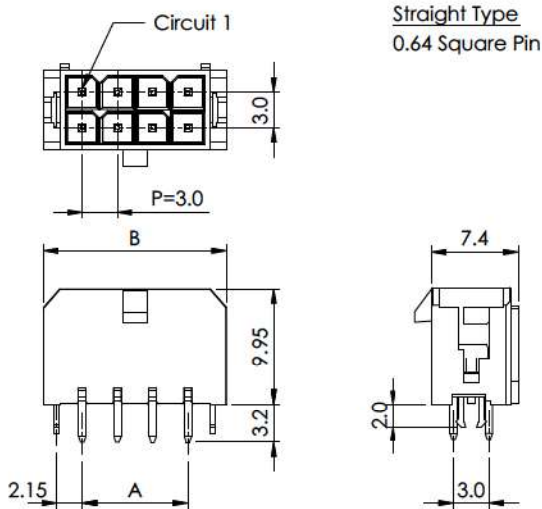
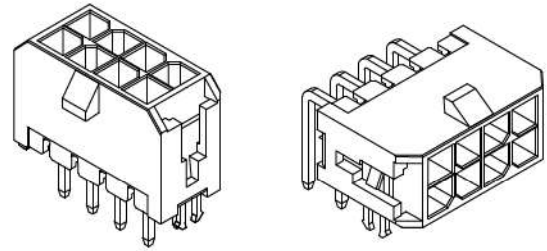

## Ordering Information HEAT SOLDER SERIES

Circuits	Part No.		Dimension	
	Straight	Right Angle	A	B
2	3001P02 49V	3002P02 49V	NA	6.7
4	3001P04 49V	3002P04 49V	3.00	9.7
6	3001P06 49V	3002P06 49V	6.00	12.7
8	3001P08 49V	3002P08 49V	9.00	15.7
10	3001P10 49V	3002P10 49V	12.00	18.7
12	3001P12 49V	3002P12 49V	15.00	21.7
14	3001P14 49V	3002P14 49V	18.00	24.7
16	3001P16 49V	3002P16 49V	21.00	27.7
18	3001P18 49V	3002P18 49V	24.00	30.7
20	3001P20 49V	3002P20 49V	27.00	33.7
22	3001P22 49V	3002P22 49V	30.00	36.7
24	3001P24 49V	3002P24 49V	33.00	39.7

## Material

Part	Material / Finish
Base	High HDT Nylon-GF 94V-0, black color
Contact	Brass, Matte tin-plated
Metal peg	Brass, Matte tin-plated

### ※ PART NUMBER ASSIGNMENT:

ex. 3001P XX 4 9 X ( Straight Type )

ex. 3002P XX 4 9 X ( Right-angle Type )

XX... Circuit Nos (PIN Numbers)

X... Plating Selection: 1... Gold flash, V... Matte Tin

### ※ Color Identification: the following alphabet shall be put;

ex. 3001P 06 4 9 X - R

ex. 3002P 06 4 9 X - E

06... Circuit no. R... red, E... blue color

### ※ P/N for Halogen-Free replacement:

ex. 3001P 10 4 9 X - B NH

ex. 3002P 10 4 9 X - B NH

10... Circuit no. B... black color NH... Halogen-free

## P.C. Board Layout / Assembly Layout

### Straight Type

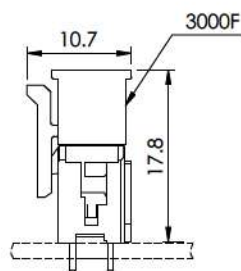
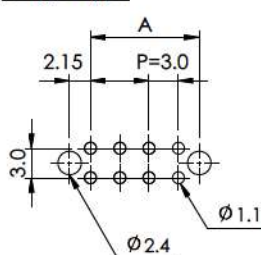

### Right -angle Type

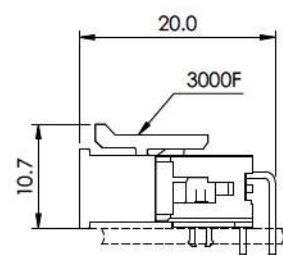
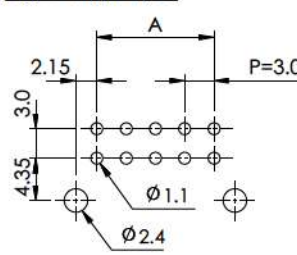

# 3.0 Pitch 3000 SERIES CONNECTOR



3.0 mm Pitch Wire-to-Board Connector



## Specifications

- ◇ Current rating: 5A AC/DC Max.
- ◇ Voltage Range: 250V AC,DC
- ◇ Withstand Voltage: 1500V AC/Minute
- ◇ Contact Resistance: 10 mΩ Max. before environment test
- ◇ Insulation Resistance: 1000 MΩ Min.
- ◇ Temperature Range: -40° C to 105° C

## Reference

- ◇ Mates with 3000F series dual-row Plug Housing
- ◇ Certification: UL, CSA, TUV
- ◇ GWT 850° C rated product is available

## 3001P, 3002P Dual-Row SMT Header (Type-6) High Temperature

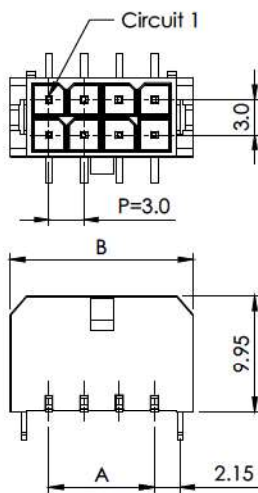
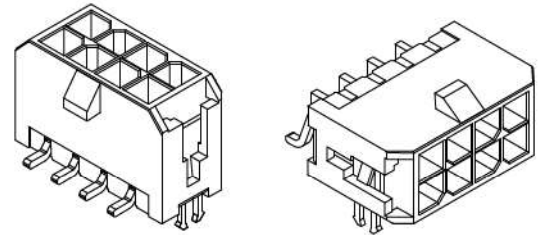

**Straight Type**  
0.64 Square contact

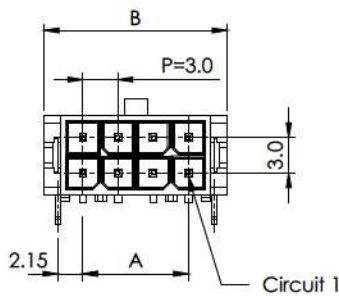
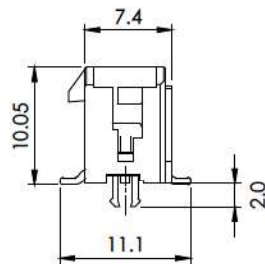

**Right-angle Type**  
0.64 Square contact

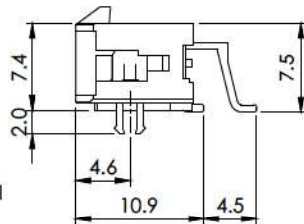

## Ordering Information REFLOW SOLDERING SERIES

Circuits	Part No.		Dimension	
	Straight	Right Angle	A	B
2	3001P02 69V	3002P02 69V	NA	6.7
4	3001P04 69V	3002P04 69V	3.00	9.7
6	3001P06 69V	3002P06 69V	6.00	12.7
8	3001P08 69V	3002P08 69V	9.00	15.7
10	3001P10 69V	3002P10 69V	12.00	18.7
12	3001P12 69V	3002P12 69V	15.00	21.7
14	3001P14 69V	3002P14 69V	18.00	24.7
16	3001P16 69V	3002P16 69V	21.00	27.7
18	3001P18 69V	3002P18 69V	24.00	30.7
20	3001P20 69V	3002P20 69V	27.00	33.7
22	3001P22 69V	3002P22 69V	30.00	36.7
24	3001P24 69V	3002P24 69V	33.00	39.7

## Material

Part	Material / Finish
Base	High HDT Nylon-GF 94V-0, black color
Contact	Brass, Matte tin-plated
Metal peg	Brass, Matte tin-plated

### ※ PART NUMBER ASSIGNMENT:

ex. 3001P XX 6 9 X ( Straight Type )

ex. 3002P XX 6 9 X ( Right-angle Type )

XX... Circuit Nos (PIN Numbers)

X... Plating Selection: 1... Gold flash, V... Matte Tin

### ※ Color Identification: the following alphabet shall be put,

ex. 3001P 06 6 9 X - R

ex. 3002P 06 6 9 X - E

06... Circuit no. R... red, E... blue color

### ※ P/N for Halogen-Free replacement:

ex. 3001P 10 6 9 X - B NH

ex. 3002P 10 6 9 X - B NH

10... Circuit no. B... black color NH... Halogen-free

## P.C. Board Layout / Assembly Layout

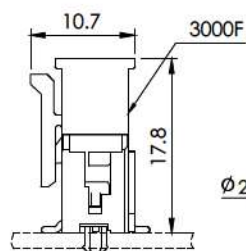
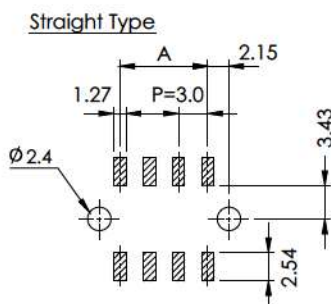

### Right -angle Type

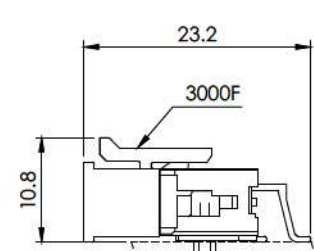
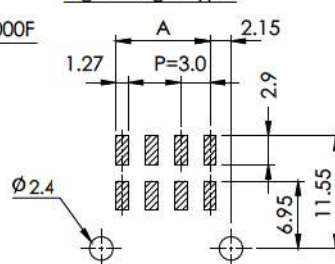

# 3.0 Pitch 3000 SERIES CONNECTOR



3.0 mm Pitch Wire-to-Board Connector

RoHS REACH LF HFA GWT

## Specifications

- ◇ Current rating: 5A AC/DC Max.
- ◇ Voltage Range: 250V AC,DC
- ◇ Withstand Voltage: 1500V AC/Minute
- ◇ Contact Resistance: 10 mΩ Max. before environment test
- ◇ Insulation Resistance: 1000 MΩ Min.
- ◇ Temperature Range: -40° C to 105° C

## Reference

- ◇ Mates with 3000F series dual-row Plug Housing
- ◇ Certification: UL, CSA, TUV
- ◇ GWT 850° C rated product is available

## 3001P, 3002P Dual-Row SMT Header (Type-8) High Temperature

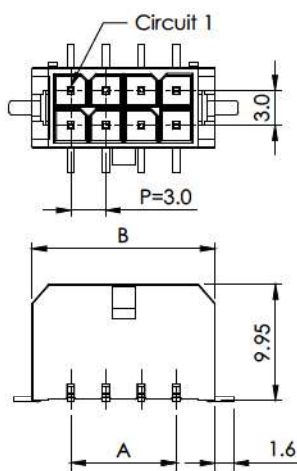
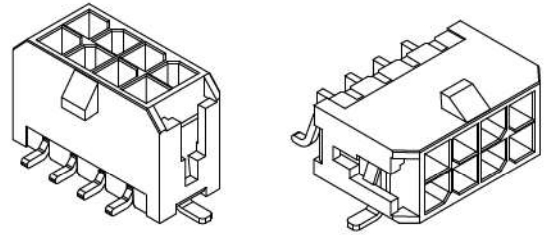

**Straight Type**  
0.64 Square contact

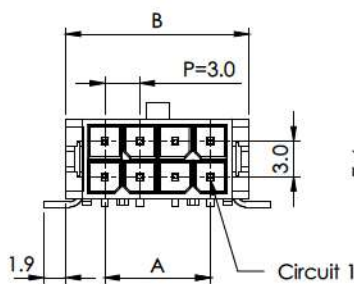

**Right-angle Type**  
0.64 Square contact

## Ordering Information

## REFLOW SOLDERING SERIES

Circuits	Part No.		Dimension		
	Straight	Right Angle	A	B	C
2	3001P02 89V	3002P02 89V	NA	6.7	11.2
4	3001P04 89V	3002P04 89V	3.00	9.7	14.2
6	3001P06 89V	3002P06 89V	6.00	12.7	17.2
8	3001P08 89V	3002P08 89V	9.00	15.7	20.2
10	3001P10 89V	3002P10 89V	12.00	18.7	23.2
12	3001P12 89V	3002P12 89V	15.00	21.7	26.2
14	3001P14 89V	3002P14 89V	18.00	24.7	29.2
16	3001P16 89V	3002P16 89V	21.00	27.7	32.2
18	3001P18 89V	3002P18 89V	24.00	30.7	35.2
20	3001P20 89V	3002P20 89V	27.00	33.7	38.2
22	3001P22 89V	3002P22 89V	30.00	36.7	41.2
24	3001P24 89V	3002P24 89V	33.00	39.7	44.2

## Material

Part	Material / Finish
Base	High HDT Nylon-GF 94V-0, black color
Contact	Brass, Matte tin-plated
Metal peg	Brass, Matte tin-plated

### ※ PART NUMBER ASSIGNMENT:

ex. 3001P XX 8 9 X ( Straight Type )

ex. 3002P XX 8 9 X ( Right-angle Type )

XX... Circuit Nos (PIN Numbers)

X... Plating Selection: 1... Gold flash, V... Matte Tin

### ※ Color Identification: the following alphabet shall be put:

ex. 3001P 06 8 9 X - R

ex. 3002P 06 8 9 X - E

06... Circuit no. R... red, E... blue color

### ※ P/N for Halogen-Free replacement:

ex. 3001P 10 8 9 X - B NH

ex. 3002P 10 8 9 X - B NH

10... Circuit no. B... black color NH... Halogen-free

### ※ SMT Embossed Tape Packing Information:

Q' ty per 330 mm Dia. Panel: 250 pcs/Reel (3001P), 250 pcs/Reel (3002P)

## P.C. Board Layout / Assembly Layout

### Straight Type

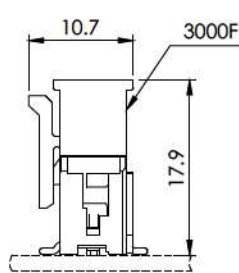
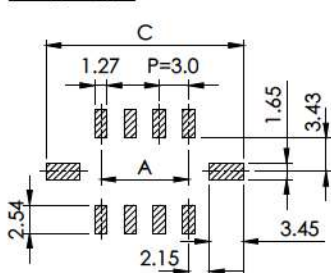

### Right -angle Type

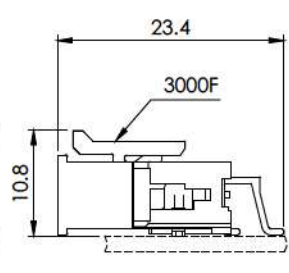
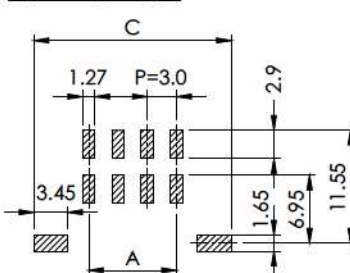



# 3.0 Pitch 3000 SERIES CONNECTOR



3.0 mm Pitch Wire-to-Board Connector

RoHS REACH LF HFA GWT

## Specifications

- ◇ Current rating: 5A AC/DC Max.
- ◇ Voltage Range: 250V AC,DC
- ◇ Withstand Voltage: 1500V AC/Minute
- ◇ Contact Resistance: 10 mΩ Max. before environment test
- ◇ Insulation Resistance: 1000 MΩ Min.
- ◇ Temperature Range: -40° C to 105° C

## Reference

- ◇ Mates with 3000F series dual-row Plug Housing
- ◇ Certification: refer to 3000F series
- ◇ GWT 850° C rated product is available

## 3001P, 3002P Dual-Row SMT Header (Type 8A) High Temperature

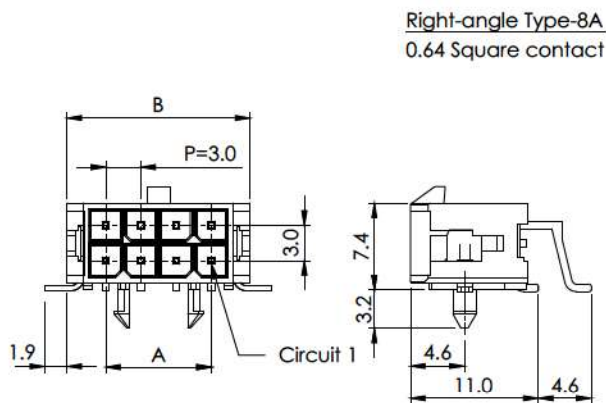
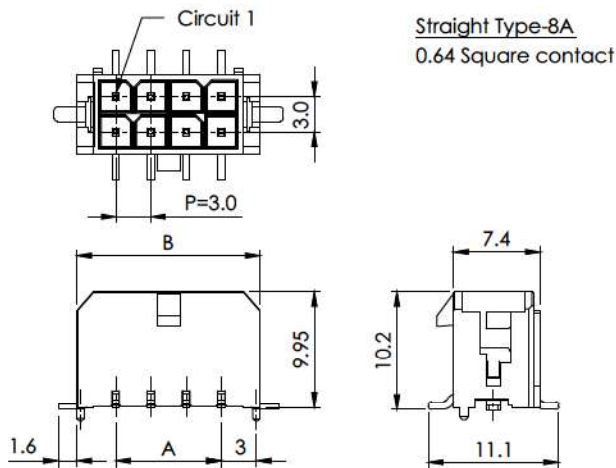
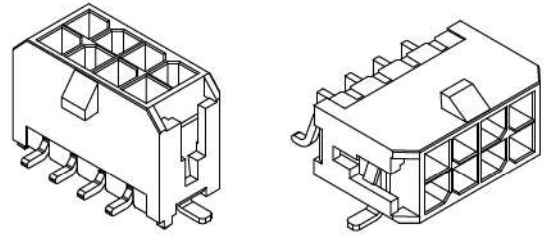

## Ordering Information

## REFLOW SOLDERING SERIES

Circuits	Part No.		Dimension		
	Straight	Right Angle	A	B	C
2	3001P02 8A9V	3002P02 8A9V	NA	6.7	11.2
4	3001P04 8A9V	3002P04 8A9V	3.00	9.7	14.2
6	3001P06 8A9V	3002P06 8A9V	6.00	12.7	17.2
8	3001P08 8A9V	3002P08 8A9V	9.00	15.7	20.2
10	3001P10 8A9V	3002P10 8A9V	12.00	18.7	23.2
12	3001P12 8A9V	3002P12 8A9V	15.00	21.7	26.2
14	3001P14 8A9V	3002P14 8A9V	18.00	24.7	29.2
16	3001P16 8A9V	3002P16 8A9V	21.00	27.7	32.2
18	3001P18 8A9V	3002P18 8A9V	24.00	30.7	35.2
20	3001P20 8A9V	3002P20 8A9V	27.00	33.7	38.2
22	3001P22 8A9V	3002P22 8A9V	30.00	36.7	41.2
24	3001P24 8A9V	3002P24 8A9V	33.00	39.7	44.2

## Material

Part	Material / Finish
Base	High HDT Nylon-GF 94V-0, black color
Contact	Brass, Matte tin-plated
Metal peg	Brass, Matte tin-plated

### ※ PART NUMBER ASSIGNMENT:

ex. 3001P XX 8A 9 X (Straight Type)

ex. 3002P XX 8A 9 X (Right-angle Type)

XX... Circuit Nos (PIN Numbers)

X... Plating Selection: 1... Gold flash, V... Matte Tin

### ※ Color Identification: the following alphabet shall be put,

ex. 3001P 06 8A 9 X - R

ex. 3002P 06 8A 9 X - E

06... Circuit no. R... red, E... blue color

### ※ P/N for Halogen-Free replacement:

ex. 3001P 10 8A 9 X - B NH

ex. 3002P 10 8A 9 X - B NH

10... Circuit no. B... black color NH... Halogen-free

## P.C. Board Layout / Assembly Layout

