

# 3.96 Pitch 3360 SERIES CONNECTOR



3.96 mm Pitch Wire-to-Board Connector



## Specifications

- ◇ Current rating: 7A AC/DC Max.
- ◇ Voltage Range: 250V AC,DC
- ◇ Withstand Voltage: 1500V AC/Minute
- ◇ Contact Resistance: 7 mΩ Max. before environment test
- ◇ Insulation Resistance: 1000 MΩ Min.
- ◇ Temperature Range: -25° C to 90° C

## Reference

- ◇ Mates with 3061P, 3062P Type-E and Type-E1 series PCB Header

## 3360R IDC Plug Housing

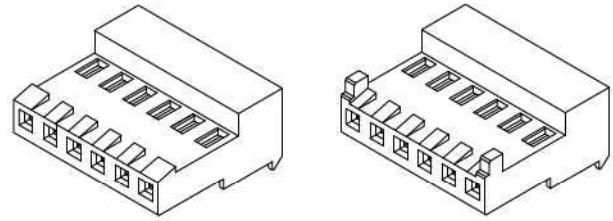

3360R Type-1

3360R Type-2

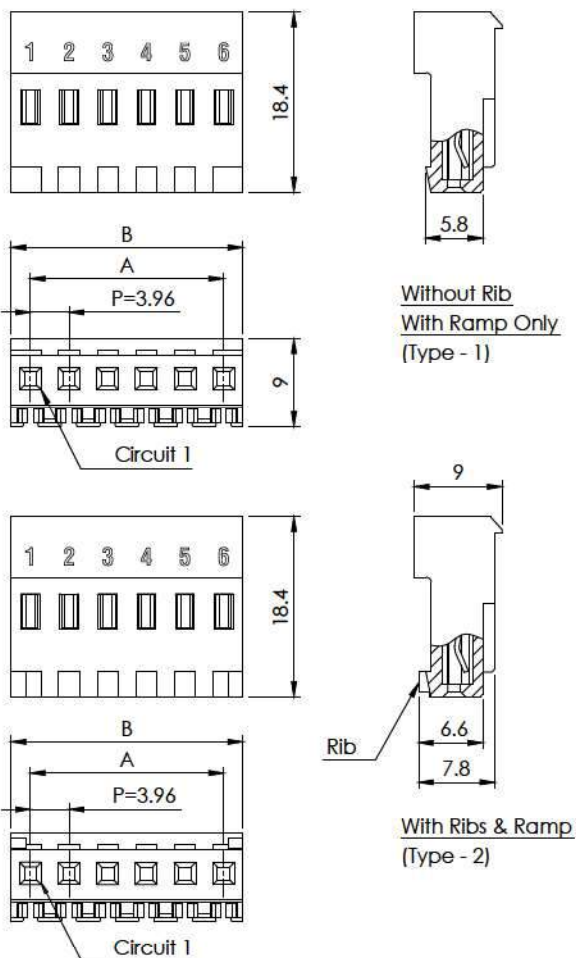

## Ordering Information

Circuits	Part No.		Dimension	
	Without Ribs	With Ribs	A	B
2	3360R0212T-X	3360R0222T-X	3.96	7.92
3	3360R0312T-X	3360R0322T-X	7.92	11.88
4	3360R0412T-X	3360R0422T-X	11.88	15.84
5	3360R0512T-X	3360R0522T-X	15.84	19.80
6	3360R0612T-X	3360R0622T-X	19.80	23.76
7	3360R0712T-X	3360R0722T-X	23.76	27.72
8	3360R0812T-X	3360R0822T-X	27.72	31.68
9	3360R0912T-X	3360R0922T-X	31.68	35.64
10	3360R1012T-X	3360R1022T-X	35.64	39.60
11	3360R1112T-X	3360R1122T-X	39.60	43.56
12	3360R1212T-X	3360R1222T-X	43.56	47.52
13	3360R1312T-X	3360R1322T-X	47.52	51.48
14	3360R1412T-X	3360R1422T-X	51.48	55.44

## Material

Part	Material	Applicable Wire Gauge	Color Coding = X
IDC Plug	Nylon 66 94V-2	26 AWG	X = E - Blue
		24 AWG	X = S - Natural
		22 AWG	X = R - Red
		20 AWG	X = Y - Yellow
		18 AWG	X = D - Orange

## Assembly Layout

### Straight Type

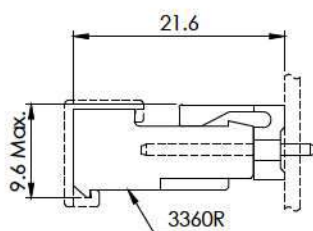

### Right-Angle Type

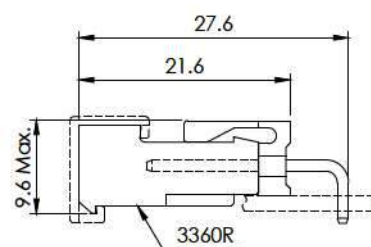

# 3.96 Pitch 3960 SERIES CONNECTOR



3.96 mm Pitch Wire-to-Board Connector



## Specifications

- ◇ Current rating: 7A AC/DC Max.
- ◇ Voltage Range: 250V AC,DC
- ◇ Withstand Voltage: 1500V AC/Minute
- ◇ Contact Resistance: 10 mΩ Max. before environment test
- ◇ Insulation Resistance: 1000 MΩ Min.
- ◇ Temperature Range: -40° C to 85° C

## Reference

- ◇ Mates with 3961P, 3962P Series Header
- ◇ Use with 3963T Crimp Terminal
- ◇ Certification: UL, CSA, TUV
- ◇ Applicable wire gauge: AWG 18 - 22 and AWG 16 - 20

3960S Plug Housing  
3960A T.P.A.

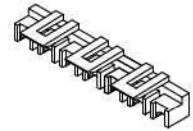
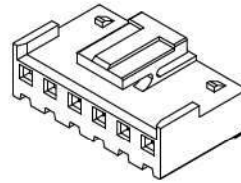

3960A (T.P.A.)

3960S Plug Housing

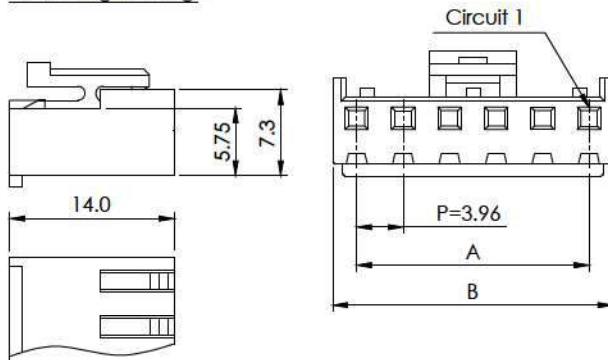

3960A (T.P.A.)

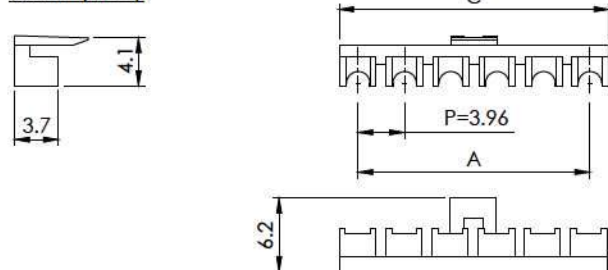

## Ordering Information

Circuits	Part No.		Dimension		
	Housing	T.P.A	A	B	C
2	3960S02 00	3960A02 01	3.96	8.02	7.06
3	3960S03 00	3960A03 01	7.92	11.98	11.02
4	3960S04 00	3960A04 01	11.88	15.94	14.98
5	3960S05 00	3960A05 01	15.84	19.90	18.94
6	3960S06 00	3960A06 01	19.80	23.86	22.90
7	3960S07 00	3960A07 01	23.76	27.82	26.86
8	3960S08 00	3960A08 01	27.72	31.78	30.82
9	3960S09 00	3960A09 01	31.68	35.74	34.78
10	3960S10 00	3960A10 01	35.64	39.70	38.74
11	3960S11 00	3960A11 01	39.60	43.66	42.70
12	3960S12 00	3960A12 01	43.56	47.62	46.66
13	3960S13 00	3960A13 01	47.52	51.58	50.62
14	3960S14 00	3960A14 01	51.48	55.54	54.58
15	3960S15 00	3960A15 01	55.44	59.50	58.54

## Material

Part	Material / Finish
Housing	Nylon 66 94V-0, white (natural)
T.P.A	Glass-filled Nylon 66 94V-0, Light ivory color

※ Color Identification: the following alphabet shall be put,  
 ex. 3960S 04 0 0 - B  
 ex. 3960A 04 0 1 - R  
 04... Circuit no.      B... Black, E... Blue, R... Red color

## Reference

- ◇ Use with 3960S, 5000S, 5080S Type-N Plug Housing

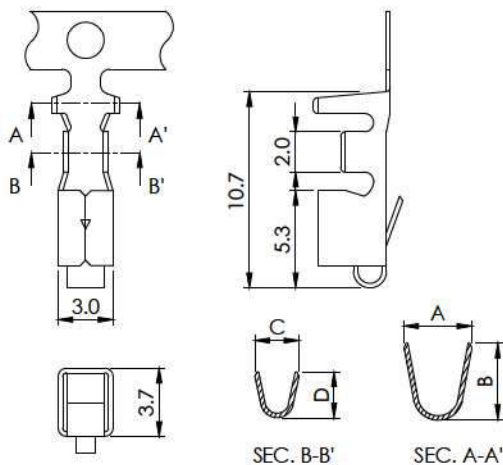

3963T Crimp Terminal

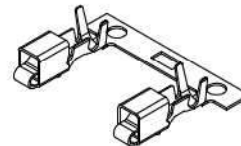

## Ordering Information

Part No.	Applicable Wire		Q'ty / Reel
	AWG #	Insulation O.D. mm	
3963T012R	18 - 22	2.7 Max.	3,500
3963T022R	16 - 20	3.0 Max.	3,000

Part No.	A	B	C	D
3963T012R	3.7	4.2	2.4	2.5
3963T022R	4.0	4.8	3.1	3.4

Material: Brass, Tin-plated



# 3.96 Pitch 3960 SERIES CONNECTOR



3.96 mm Pitch Wire-to-Board Connector

RoHS REACH LF HFA GWT

## 3961P, 3962P DIP Header

### Specifications

- ◇ Current rating: 7A AC/DC Max.
- ◇ Voltage Range: 250V AC,DC
- ◇ Withstand Voltage: 1500V AC/Minute
- ◇ Contact Resistance: 10 mΩ Max. before environment test
- ◇ Insulation Resistance: 1000 MΩ Min.
- ◇ Temperature Range: -40° C to 85° C

### Reference

- ◇ Mates with 3960S Series Plug Housing
- ◇ Certification: refer to 3960S series
- ◇ GWT 850° C rated product is available

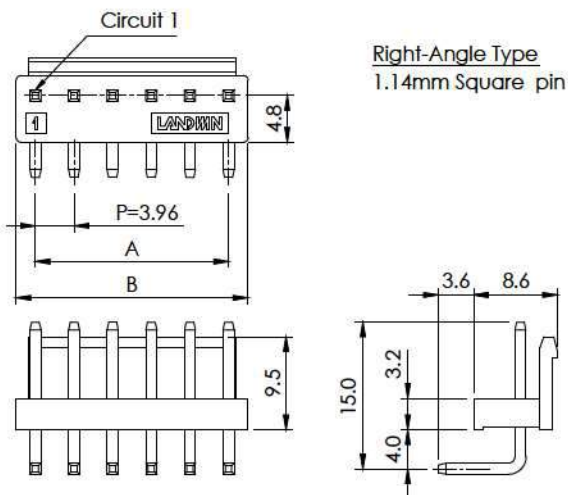
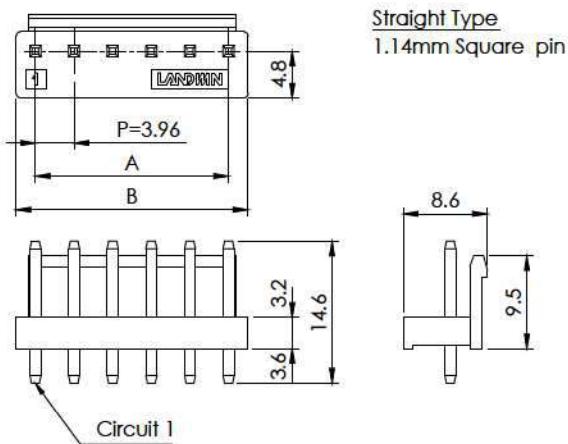
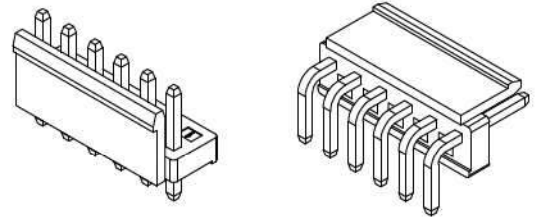

### Ordering Information

Circuits	Part No.		Dimension	
	Straight	Right Angle	A	B
2	3961P02 00T	3962P02 00T	3.96	7.92
3	3961P03 00T	3962P03 00T	7.92	11.88
4	3961P04 00T	3962P04 00T	11.88	15.84
5	3961P05 00T	3962P05 00T	15.84	19.80
6	3961P06 00T	3962P06 00T	19.80	23.76
7	3961P07 00T	3962P07 00T	23.76	27.72
8	3961P08 00T	3962P08 00T	27.72	31.68
9	3961P09 00T	3962P09 00T	31.68	35.64
10	3961P10 00T	3962P10 00T	35.64	39.60
11	3961P11 00T	3962P11 00T	39.60	43.56
12	3961P12 00T	3962P12 00T	43.56	47.52
13	3961P13 00T	3962P13 00T	47.52	51.48
14	3961P14 00T	3962P14 00T	51.48	55.44
15	3961P15 00T	3962P15 00T	55.44	59.40

### Material

Part	Material / Finish
Base	Nylon 66 94V-0, white (natural color)
Contact	Brass, Tin-plated

※ Color Identification: the following alphabet shall be put,  
 ex. 3961P 04 00 00 X (natural color)  
 ex. 3961P 04 00 00 X -B  
 ex. 3962P 04 00 00 X -R  
 04... Circuit no.                      B... Black, E... Blue, R... Red color  
 X... Plating Selection: T... Tin, V... Matte Tin

### P.C. Board Layout / Assembly Layout

#### Straight Type

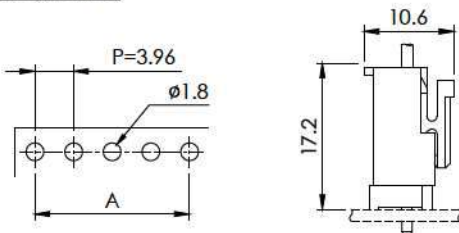

#### Right-Angle Type

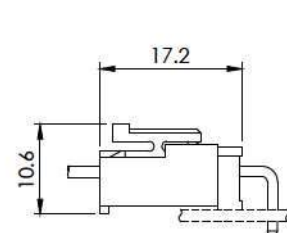

# 3.96 Pitch 3960 SERIES CONNECTOR



3.96 mm Pitch Wire-to-Board Connector



## 3961P, 3962P DIP Header (Type 1)

### Specifications

- ◇ Current rating: 7A AC/DC Max.
- ◇ Voltage Range: 250V AC,DC
- ◇ Withstand Voltage: 1500V AC/Minute
- ◇ Contact Resistance: 10 mΩ Max. before environment test
- ◇ Insulation Resistance: 1000 MΩ Min.
- ◇ Temperature Range: -40° C to 85° C

### Reference

- ◇ Mates with 3960S Series Plug Housing
- ◇ Certification: refer to 3960S series
- ◇ GWT 850° C rated product is available

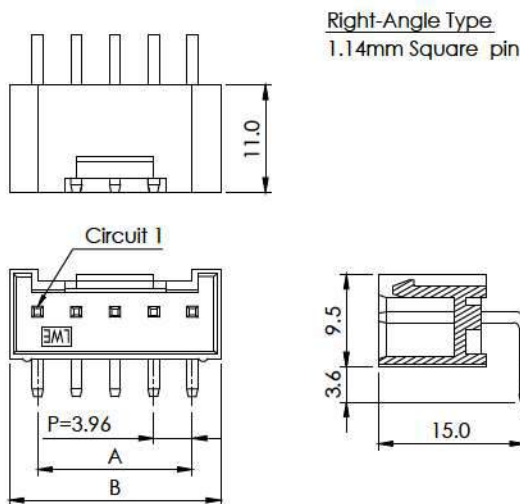
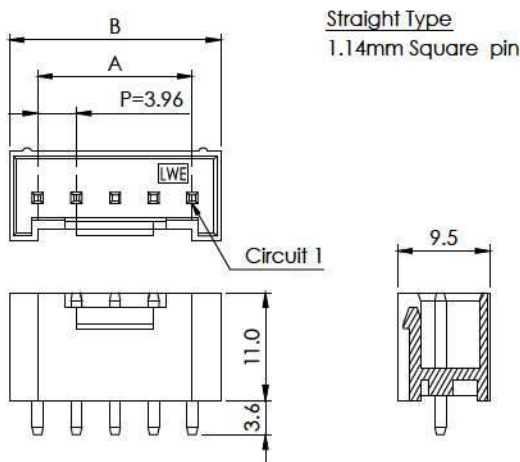
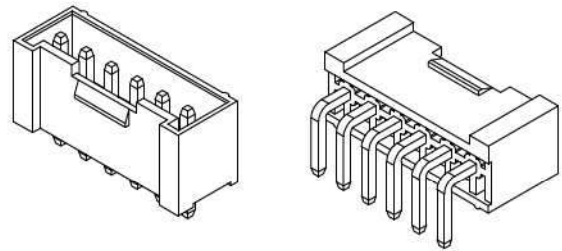

### Ordering Information

Circuits	Part No.		Dimension	
	Straight	Right Angle	A	B
2	3961P02 10T	3962P02 10T	3.96	9.80
3	3961P03 10T	3962P03 10T	7.92	13.76
4	3961P04 10T	3962P04 10T	11.88	17.72
5	3961P05 10T	3962P05 10T	15.84	21.68
6	3961P06 10T	3962P06 10T	19.80	25.64
7	3961P07 10T	3962P07 10T	23.76	29.60
8	3961P08 10T	3962P08 10T	27.72	33.56
9	3961P09 10T	3962P09 10T	31.68	37.52
10	3961P10 10T	3962P10 10T	35.64	41.48
11	3961P11 10T	3962P11 10T	39.60	45.44
12	3961P12 10T	3962P12 10T	43.56	49.40

### Material

Part	Material / Finish
Base	Nylon 66 94V-0, white (natural color)
Contact	Brass, Tin-plated

※ Color Identification: the following alphabet shall be put,

ex. 3961P 04 1 0 X (natural color)

ex. 3961P 04 1 0 X - B

ex. 3962P 04 1 0 X - R

04... Circuit no. B... Black, E... Blue, R... Red color

X... Plating Selection: T... Tin, V... Matte Tin

### P.C. Board Layout / Assembly Layout

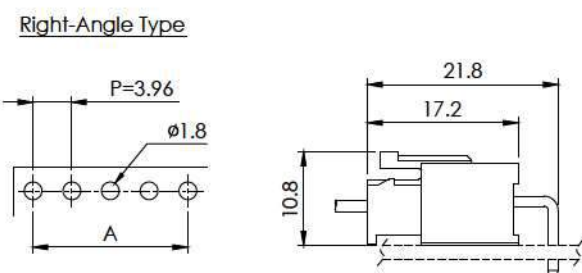
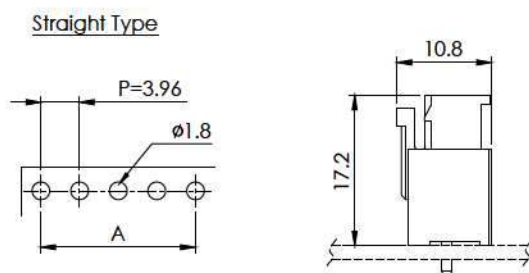



# 3.96 Pitch 3960 SERIES CONNECTOR



3.96 mm Pitch Wire-to-Board Connector

RoHS REACH LF HFA GWT

## Specifications

- ◇ Current rating: 7A AC/DC Max.
- ◇ Voltage Range: 250V AC,DC
- ◇ Withstand Voltage: 1500V AC/Minute
- ◇ Contact Resistance: 10 mΩ Max. before environment test
- ◇ Insulation Resistance: 1000 MΩ Min.
- ◇ Temperature Range: -40° C to 85° C

## Reference

- ◇ Mates with 3960S Series Plug Housing
- ◇ Certification: refer to 3960S series
- ◇ GWT 850° C rated product is available

3961P, 3962P DIP Header (Type NB)  
Pitch = 7.92 mm

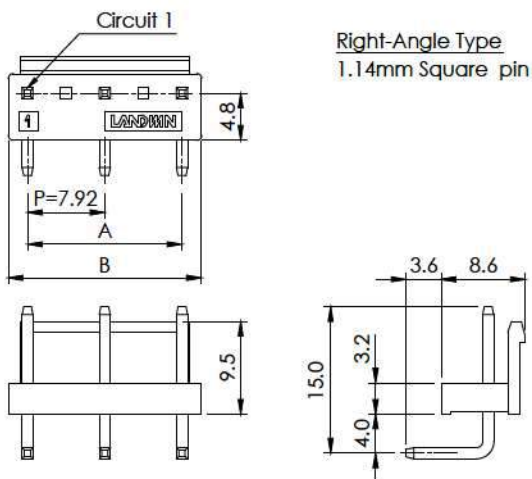
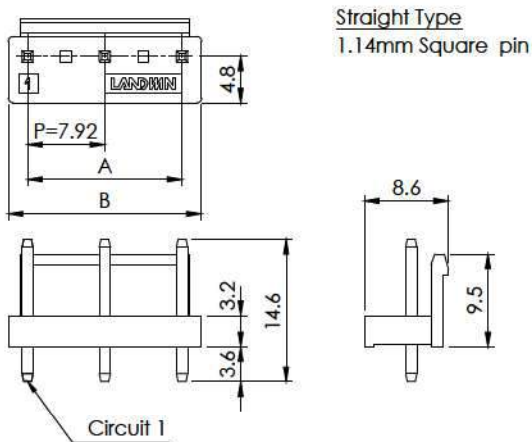
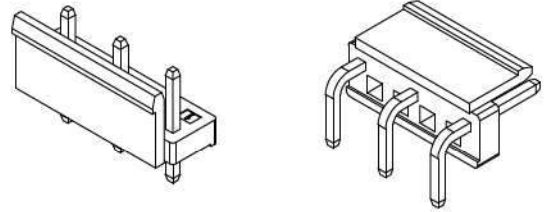

## Ordering Information

Circuits	Part No.		Dimension	
	Straight	Right Angle	A	B
2	3961P03 00T-SN02	3962P03 00T-SN02	7.92	11.88
3	3961P05 00T-SNB2	3962P05 00T-SNB2	15.84	19.80
4	3961P07 00T-SNC2	3962P07 00T-SNC2	23.76	27.72
5	3961P09 00T-SND2	3962P09 00T-SND2	31.68	35.64
6	3961P11 00T-SNE2	3962P11 00T-SNE2	39.60	43.56
7	3961P13 00T-SNF2	3962P13 00T-SNF2	47.52	51.48
8	3961P15 00T-SNG2	3962P15 00T-SNG2	55.44	59.40

## Material

Part	Material / Finish
Base	Nylon 66 94V-0, White (natural color)
Contact	Brass, Tin-plated

※ Color Identification: the following alphabet shall be put,

ex. 3961P 05 0 0 X - S NB2

ex. 3962P 05 0 0 X - B NB2

05... Circuit no.

B... Black, R... Red, S... white /natural color

X... Plating Selection: T... Tin, V... Matte Tin

## P.C. Board Layout / Assembly Layout

### Straight Type

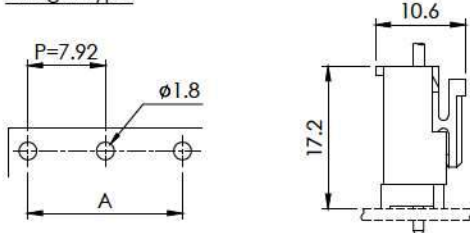

### Right-Angle Type

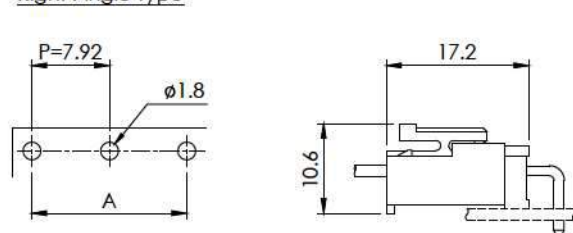

# 3.96 Pitch 3960 SERIES CONNECTOR



3.96 mm Pitch Wire-to-Board Connector



## Specifications

- ◇ Current rating: 7A AC/DC Max.
- ◇ Voltage Range: 250V AC,DC
- ◇ Withstand Voltage: 1500V AC/Minute
- ◇ Contact Resistance: 10 mΩ Max. before environment test
- ◇ Insulation Resistance: 1000 MΩ Min.
- ◇ Temperature Range: -40° C to 105° C

## Reference

- ◇ Mates with 3961P, 3962P Type-N2 High Temperature Header
- ◇ Use with 3963T Crimp Terminal
- ◇ Certification: refer to 3960S series
- ◇ GWT 850° C rated product is available
- ◇ Applicable wire gauge: AWG 18 - 22 and AWG 16 - 20

## 3960S Plug Housing (Type A) High-Temperature

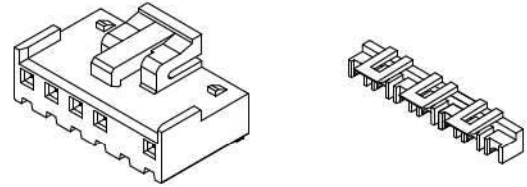

3960S Housing

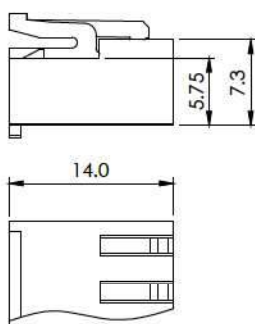

Circuit 1

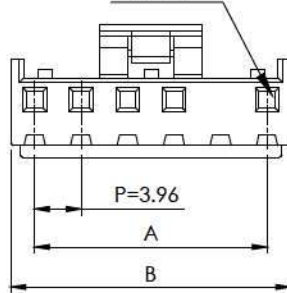

3960A (T.P.A)

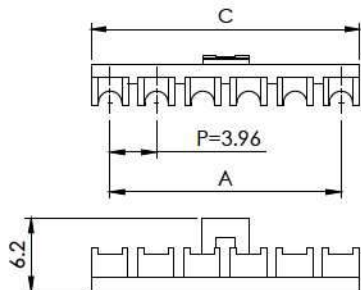
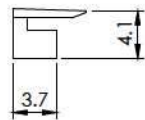

## Ordering Information

## HIGH-TEMPERATURE

Circuits	Part No.		Dimension		
	Housing	T.P.A	A	B	C
2	3960S02 A1	3960A03 01	7.92	11.98	11.02
3	3960S03 A1	3960A04 01	11.88	15.94	14.98
4	3960S04 A1	3960A05 01	15.84	19.90	18.94
5	3960S05 A1	3960A06 01	19.80	23.86	22.90
6	3960S06 A1	3960A07 01	23.76	27.82	26.86
7	3960S07 A1	3960A08 01	27.72	31.78	30.82
8	3960S08 A1	3960A09 01	31.68	35.74	34.78
9	3960S09 A1	3960A10 01	35.64	39.70	38.74
10	3960S10 A1	3960A11 01	39.60	43.66	42.70
11	3960S11 A1	3960A12 01	43.56	47.62	46.66
12	3960S12 A1	3960A13 01	47.52	51.58	50.62
13	3960S13 A1	3960A14 01	51.48	55.54	54.58
14	3960S14 A1	3960A15 01	55.44	59.50	58.54

## Material

Part	Material / Finish
Housing	Glass-filled Nylon 66 94V-0, Light ivory color
T.P.A	Glass-filled Nylon 66 94V-0, Light ivory color

※ Color Identification: the following alphabet shall be put,

ex. 3960S 04 A 1 (Light ivory / base color)

ex. 3960S 04 A 1 -B

ex. 3960A 04 0 1 (Light ivory / base color)

ex. 3960A 04 0 1 -R

04... Circuit no. B... Black, R... Red (color selection)

## Reference

- ◇ Use with 3960S, 5000S, 5080S Type-N Plug Housing

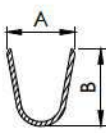
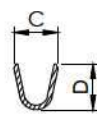
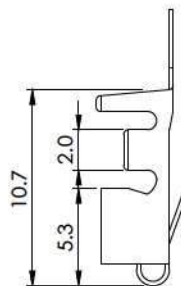
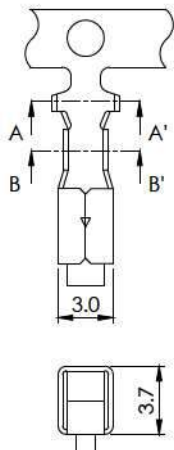

SEC. B-B'

SEC. A-A'

## 3963T Crimp Terminal High-Temperature

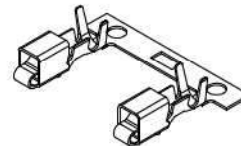

## Ordering Information

Part No.	Applicable Wire		Q'ty / Reel
	AWG #	Insulation O.D. mm	
3963T012V	18 - 22	2.7 Max.	3,500
3963T022V	16 - 20	3.0 Max.	3,000

Part No.	A	B	C	D
3963T012V	3.7	4.2	2.4	2.5
3963T022V	4.0	4.8	3.1	3.4

Material: Brass, Matte Tin-plated



# 3.96 Pitch 3960 SERIES CONNECTOR



3.96 mm Pitch Wire-to-Board Connector

RoHS REACH LF HFA GWT

## Specifications

- ◇ Current rating: 7A AC/DC Max.
- ◇ Voltage Range: 250V AC,DC
- ◇ Withstand Voltage: 1500V AC/Minute
- ◇ Contact Resistance: 10 mΩ Max. before environment test
- ◇ Insulation Resistance: 1000 MΩ Min.
- ◇ Temperature Range: -40° C to 105° C

## Reference

- ◇ Mates with 3960S Type-A series plug housing
- ◇ Certification: refer to 3960S series
- ◇ GWT 850° C rated product is available

3961P, 3962P DIP Header (Type N2)  
High-Temperature

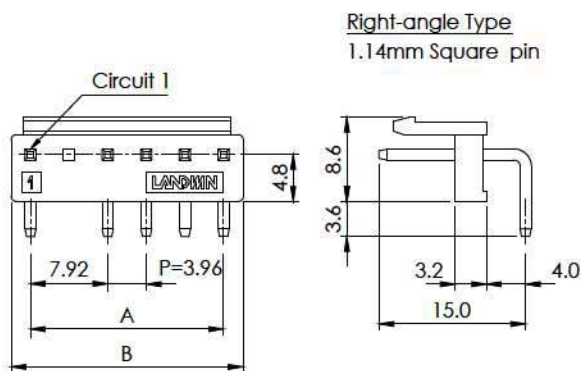
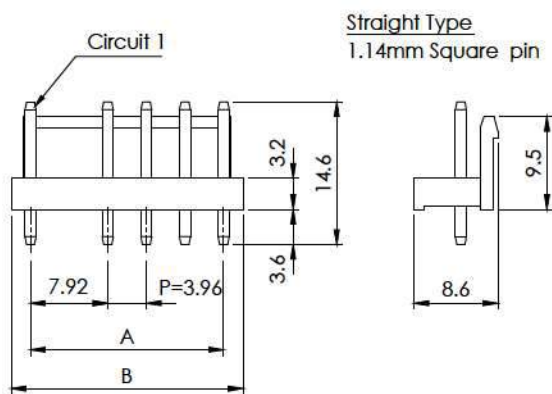
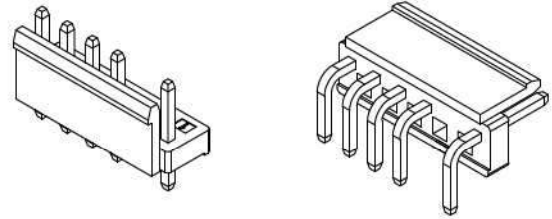

## Ordering Information

HIGH-TEMPERATURE

Circuits	Part No.		Dimension	
	Straight	Right Angle	A	B
2	3961P03 01V-SN02	3962P03 01V-SN02	7.92	11.88
3	3961P04 01V-SN02	3962P04 01V-SN02	11.88	15.84
4	3961P05 01V-SN02	3962P05 01V-SN02	15.84	19.80
5	3961P06 01V-SN02	3962P06 01V-SN02	19.80	23.76
6	3961P07 01V-SN02	3962P07 01V-SN02	23.76	27.72
7	3961P08 01V-SN02	3962P08 01V-SN02	27.72	31.68
8	3961P09 01V-SN02	3962P09 01V-SN02	31.68	35.64
9	3961P10 01V-SN02	3962P10 01V-SN02	35.64	39.60
10	3961P11 01V-SN02	3962P11 01V-SN02	39.60	43.56
11	3961P12 01V-SN02	3962P12 01V-SN02	43.56	47.52
12	3961P13 01V-SN02	3962P13 01V-SN02	47.52	51.48
13	3961P14 01V-SN02	3962P14 01V-SN02	51.48	55.44
14	3961P15 01V-SN02	3962P15 01V-SN02	55.44	59.40

## Material

Part	Material / Finish
Base	Glass-filled Nylon 66 94V-0, Light ivory color
Contact	Brass, Matte Tin-plated

※ Color Identification: the following alphabet shall be put:

ex. 3961P 04 0 1 X -S N02

ex. 3961P 04 0 1 X -B N02

ex. 3962P 04 0 1 X -R N02

04... Circuit no.

B... Black, E... Blue, R... Red, S... Natural color

X... Plating Selection: V... Matte Tin

N02... Pin no.2 void

## P.C. Board Layout / Assembly Layout

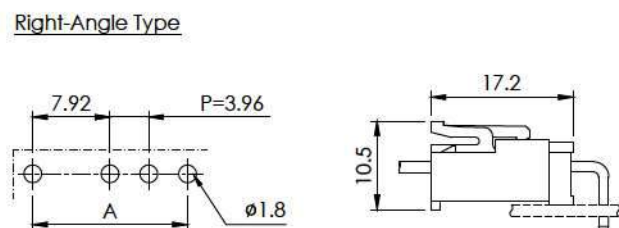
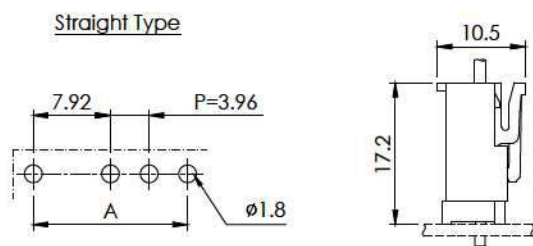

# 3.96 Pitch 3960 SERIES CONNECTOR



3.96 mm Pitch Wire-to-Board Connector

RoHS REACH LF HFA GWT

## Specifications

- ◇ Current rating: 7A AC/DC Max.
- ◇ Voltage Range: 250V AC,DC
- ◇ Withstand Voltage: 1500V AC/Minute
- ◇ Contact Resistance: 10 mΩ Max. before environment test
- ◇ Insulation Resistance: 1000 MΩ Min.
- ◇ Temperature Range: -40° C to 105° C

## Reference

- ◇ Mates with 3960S Type-A series plug housing
- ◇ Certification: refer to 3960S series
- ◇ GWT 850° C rated product is available

## 3961P, 3962P DIP Header (Type 1N2) High-Temperature

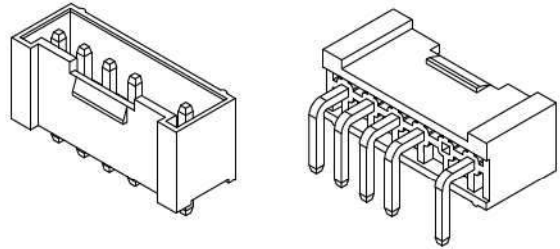

**Straight Type**  
1.14mm Square pin

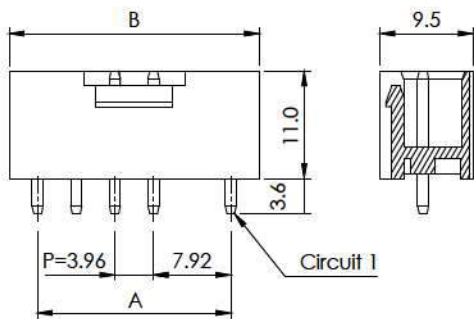

**Right-angle Type**  
1.14mm Square pin

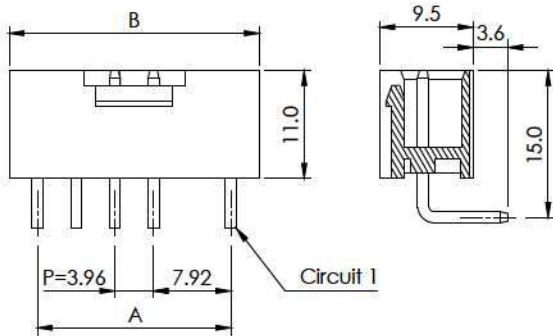

## Ordering Information

## HIGH-TEMPERATURE

Circuits	Part No.		Dimension	
	Straight	Right Angle	A	B
2	3961P03 11V-SN02	3962P03 11V-SN02	7.92	13.76
3	3961P04 11V-SN02	3962P04 11V-SN02	11.88	17.72
4	3961P05 11V-SN02	3962P05 11V-SN02	15.84	21.68
5	3961P06 11V-SN02	3962P06 11V-SN02	19.80	25.64
6	3961P07 11V-SN02	3962P07 11V-SN02	23.76	29.60
7	3961P08 11V-SN02	3962P08 11V-SN02	27.72	33.56
8	3961P09 11V-SN02	3962P09 11V-SN02	31.68	37.52
9	3961P10 11V-SN02	3962P10 11V-SN02	35.64	41.48
10	3961P11 11V-SN02	3962P11 11V-SN02	39.60	45.44
11	3961P12 11V-SN02	3962P12 11V-SN02	43.56	49.40

## Material

Part	Material / Finish
Base	Glass-filled Nylon 66 94V-0, Light ivory color
Contact	Brass, Matte Tin-plated

※ Color Identification: the following alphabet shall be put:

ex. 3961P 04 1 1 X - S N02

ex. 3961P 04 1 1 X - B N02

ex. 3962P 04 1 1 X - E N02

04... Circuit no.

B... Black, E... Blue, S... light ivory (base color)

X... Plating Selection: V... Matte Tin

N02... Pin no.2 void

## P.C. Board Layout / Assembly Layout

**Straight Type**

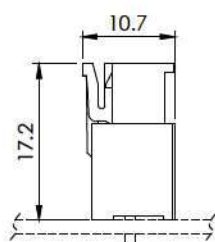
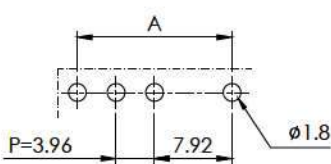

**Right-Angle Type**

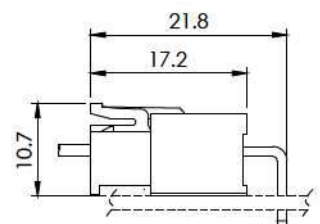
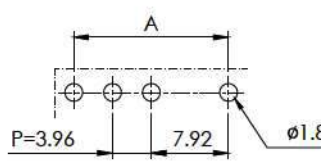



# 3.96 Pitch 3960 SERIES CONNECTOR



3.96 mm Pitch Wire-to-Board Connector

RoHS REACH LF HFA GWT

## Specifications

- ◇ Current rating: 7A AC/DC Max.
- ◇ Voltage Range: 250V AC,DC
- ◇ Withstand Voltage: 1500V AC/Minute
- ◇ Contact Resistance: 10 mΩ Max. before environment test
- ◇ Insulation Resistance: 1000 MΩ Min.
- ◇ Temperature Range: -40° C to 105° C

## Reference

- ◇ Mates with 3960S Type-XA Series Plug Housing
- ◇ Type-N2 mates with 3960S Type-A Series Plug Housing
- ◇ Certification: refer to 3960S series
- ◇ GWT 850° C rated product is available

## 3961P DIP Header (Type 3) High-Profile, for Silicon PCB

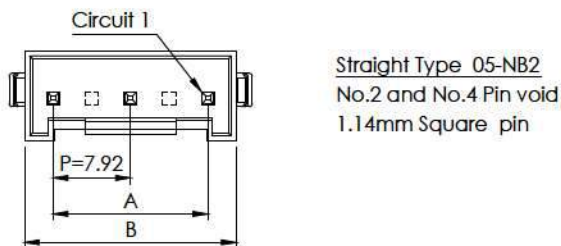
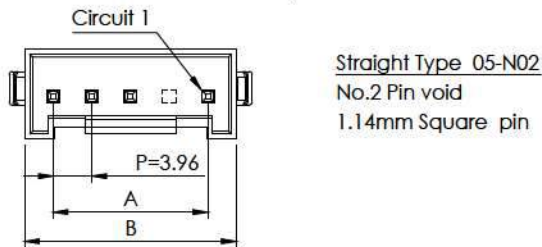
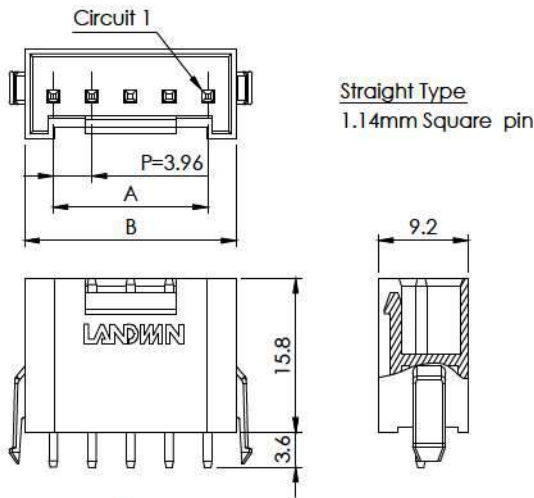
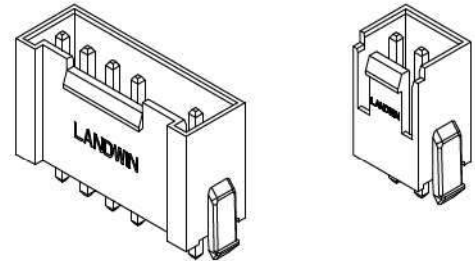

## Ordering Information HIGH-TEMPERATURE

PIN No.	Part No.		Dimension	
	Full Pins	Void Pin Type	A	B
2	3961P02 31V	N/A	3.96	9.80
3	3961P03 31V	3961P03 31V-SN02	7.92	13.76
5	3961P05 31V	3961P05 31V-SNB2	15.84	21.68

## Material

Part	Material / Finish
Base	Glass-filled Nylon 66 94V-0, Light ivory color
Contact	Brass, Matte Tin-plated

※ Color Identification: the following alphabet shall be put;

ex. 3961P 03 3 1 X - S N02 (pin no.2 void)

ex. 3961P 05 3 1 X - B NB2 (pin no.2, 4 void)

ex. 3961P 05 3 1 X - R NB2 (pin no.2, 4 void)

04... Circuit no., B... Black, S... light ivory (base color), R... Red color

X... Plating no.: V... Matte Tin

## P.C. Board Layout / Assembly Layout

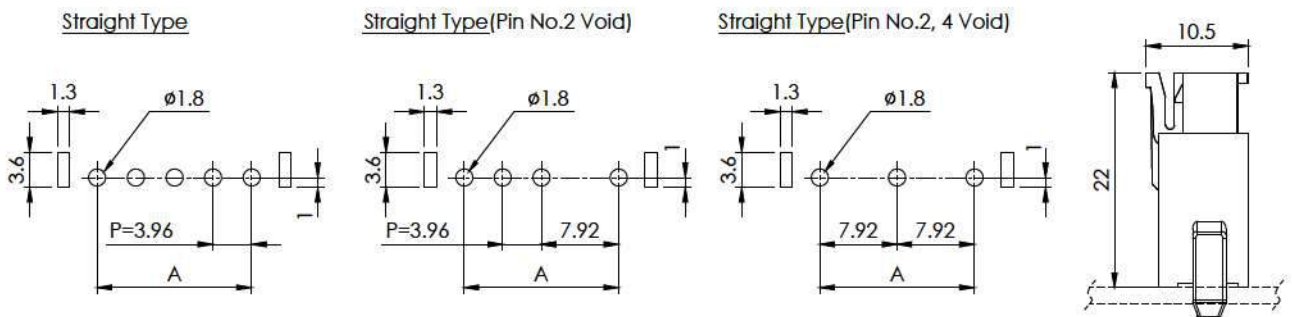

# 3.96 Pitch 3960 SERIES CONNECTOR



3.96 mm Pitch Wire-to-Board Connector

RoHS REACH LF HFA GWT

3.96 Pitch High Current Connector  
System Overview (HCCS)

(DERATING CURVE)

TEMPERATURE RISE CURVE

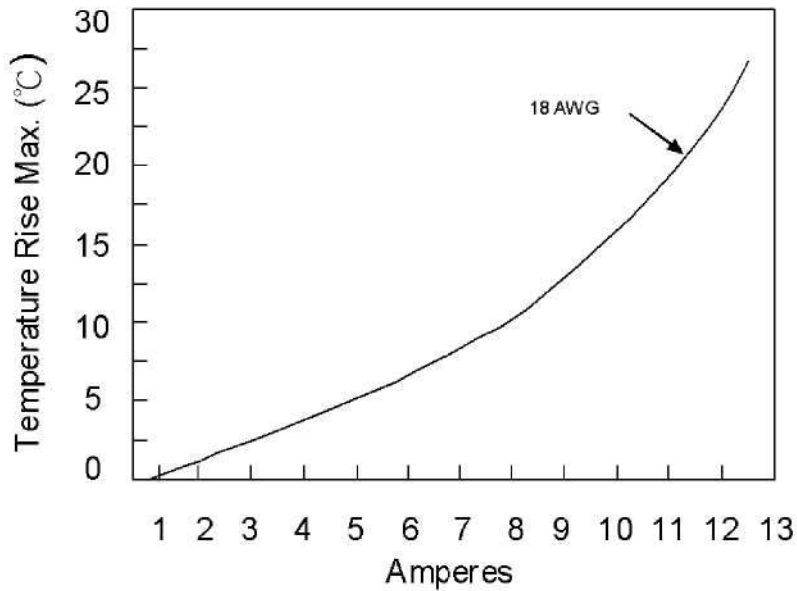

CURRENT INCREASE TABLE

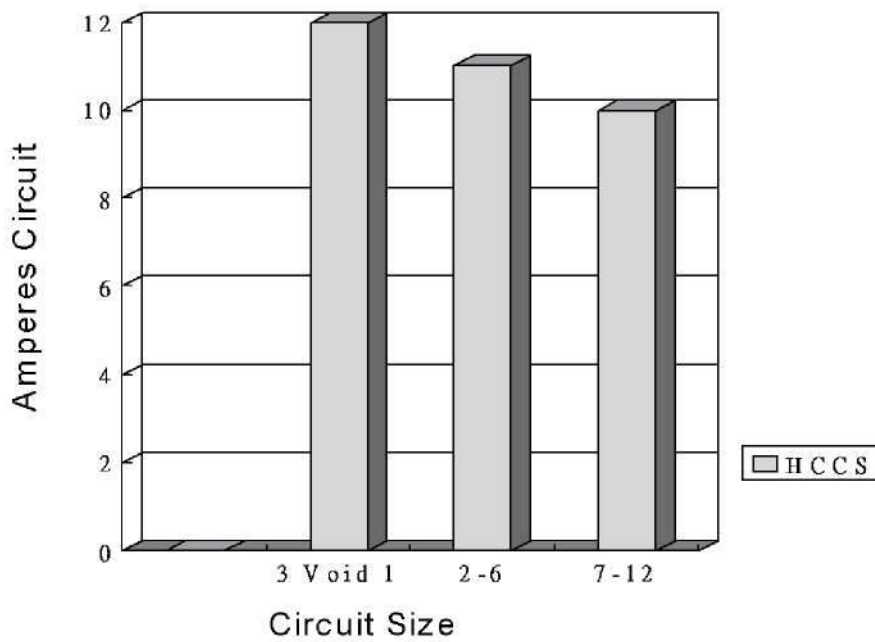



# 3.96 Pitch 3960 SERIES CONNECTOR



3.96 mm Pitch Wire-to-Board Connector



## Specifications

- ◇ Current rating: 12A AC/DC Max.
- ◇ Voltage Range: 250V AC,DC
- ◇ Withstand Voltage: 1500V AC/Minute
- ◇ Contact Resistance: 10 mΩ Max. before environment test
- ◇ Insulation Resistance: 1000 MΩ Min.
- ◇ Temperature Range: -40° C to 105° C

## Reference

- ◇ Mates with 3961P, 3962P Series Header
- ◇ Use with 3963T Crimp Terminal
- ◇ Certification: UL, CSA, TUV
- ◇ Applicable wire gauge: AWG 18 - 22 and AWG 16 - 20

## 3960S Plug Housing (Type XA) GWT Compliant

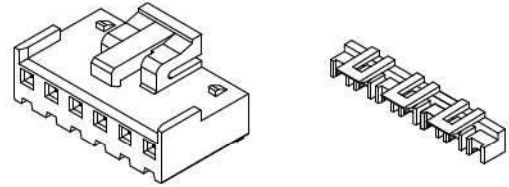

3960S Housing

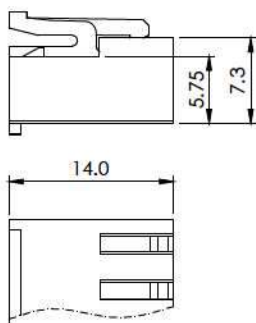

Circuit 1

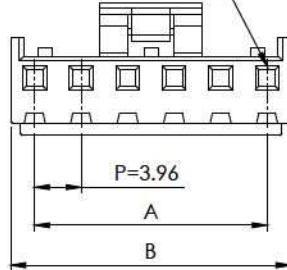

3960A (T.P.A)

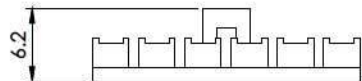
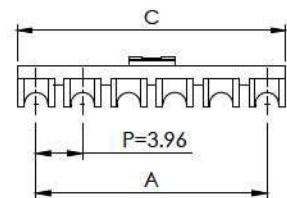
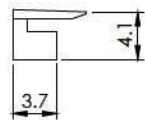

## Ordering Information

GWT 850° C Rated

PIN No.	Part No.		Dimension		
	Housing	T.P.A	A	B	C
2	3960S02 01-SA	3960A02 01-R	3.96	8.02	7.06
3	3960S03 01-SA	3960A03 01-R	7.92	11.98	11.02
4	3960S04 01-SA	3960A04 01-R	11.88	15.94	14.98
5	3960S05 01-SA	3960A05 01-R	15.84	19.90	18.94
6	3960S06 01-SA	3960A06 01-R	19.80	23.86	22.90
7	3960S07 01-SA	3960A07 01-R	23.76	27.82	26.86
8	3960S08 01-SA	3960A08 01-R	27.72	31.78	30.82
9	3960S09 01-SA	3960A09 01-R	31.68	35.74	34.78
10	3960S10 01-SA	3960A10 01-R	35.64	39.70	38.74
11	3960S11 01-SA	3960A11 01-R	39.60	43.66	42.70
12	3960S12 01-SA	3960A12 01-R	43.56	47.62	46.66
13	3960S13 01-SA	3960A13 01-R	47.52	51.58	50.62
14	3960S14 01-SA	3960A14 01-R	51.48	55.54	54.58
15	3960S15 01-SA	3960A15 01-R	55.44	59.50	58.54

## Material

Part	Material / Finish
Housing	Glass-filled Nylon 66 94V-0, Light ivory color
T.P.A	Glass-filled Nylon 66 94V-0, Light ivory color

※ Color Identification: the following alphabet shall be put,

ex. 3960S 04 0 1 - B A

ex. 3960S 04 0 1 - S A

ex. 3960A 04 0 1 - R

04... Circuit no.

Color no.: B... Black color, R... Red, S... Light ivory (base color)

## Reference

- ◇ Use with 3960S Type-XA Plug Housing

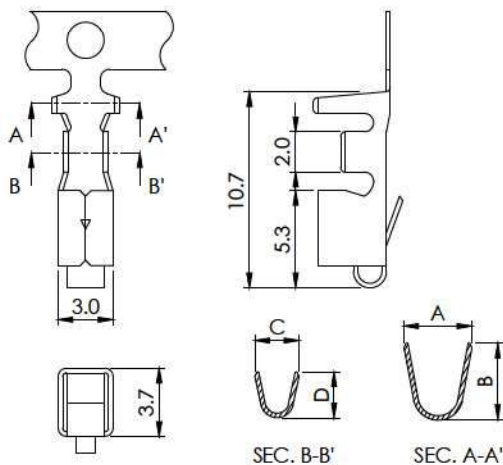

## 3963T Crimp Terminal High-Cuurent

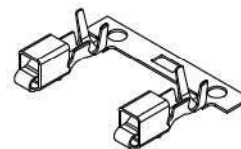

## Ordering Information

Part No.	Applicable Wire		Q'ty / Reel
	AWG #	Insulation O.D. mm	
3963T019V	18 - 22	2.7 Max.	3,500
3963T029V	16 - 20	3.0 Max.	3,000

Part No.	A	B	C	D
3963T019V	3.7	4.2	2.4	2.5
3963T029V	4.0	4.8	3.1	3.4

Material: Copper Alloy, Matte Tin-plated

# 3.96 Pitch 3960 SERIES CONNECTOR



3.96 mm Pitch Wire-to-Board Connector

RoHS REACH LF HFA GWT

## Specifications

- ◇ Current rating: 12A AC/DC Max.
- ◇ Voltage Range: 250V AC,DC
- ◇ Withstand Voltage: 1500V AC/Minute
- ◇ Contact Resistance: 10 mΩ Max. before environment test
- ◇ Insulation Resistance: 1000 MΩ Min.
- ◇ Temperature Range: -40° C to 105° C

## Reference

- ◇ Mates with 3960S Type-XA series plug housing
- ◇ Certification: refer to 3960S series
- ◇ GWT 850° C rated product is available

3961P, 3962P DIP Header (Type D)  
High-Current Application

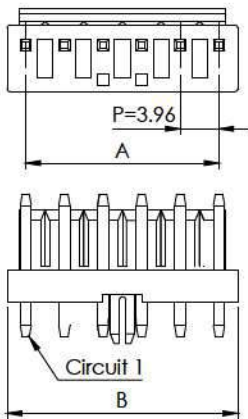
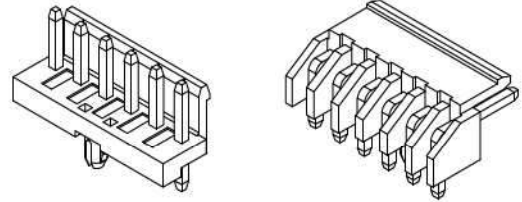

Straight Type (1.14mm SQ. Pin)

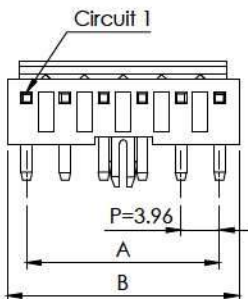
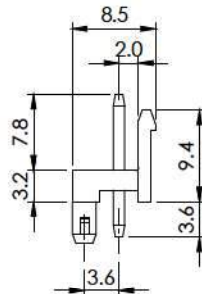

Right-Angle Type (1.14mm SQ. Pin)

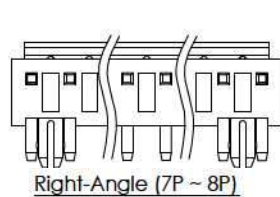
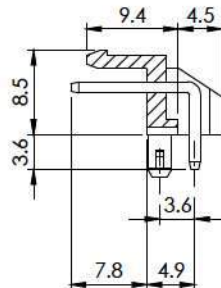

Right-Angle (7P ~ 8P)

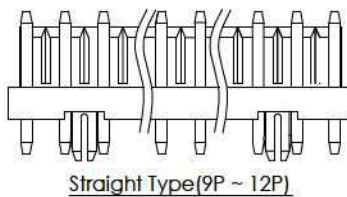

Straight Type (9P ~ 12P)

## Ordering Information

## HHCS SERIES

Circuits	Part No.		Dimension	
	Straight	Right-angle	A	B
2	3961P02 D1V -A	3962P02 D1V -A	3.96	7.92
3	3961P03 D1V -A	3962P03 D1V -A	7.92	11.88
4	3961P04 D1V -A	3962P04 D1V -A	11.88	15.84
5	3961P05 D1V -A	3962P05 D1V -A	15.84	19.80
6	3961P06 D1V -A	3962P06 D1V -A	19.80	23.76
7	3961P07 D1V -A	3962P07 D1V -A	23.76	27.72
8	3961P08 D1V -A	3962P08 D1V -A	27.72	31.68
9	3961P09 D1V -A	3962P09 D1V -A	31.68	35.64
10	3961P10 D1V -A	3962P10 D1V -A	35.64	39.60
11	3961P11 D1V -A	3962P11 D1V -A	39.60	43.56
12	3961P12 D1V -A	3962P12 D1V -A	43.56	47.52

## Material

Part	Material / Finish
Base	Glass-filled Nylon 66 94V-0, Light ivory color
Contact	Copper Alloy, Matte tin-plated

### ※ PART NUMBER ASSIGNMENT:

- ex. 3961P 04 D 1 X - A
- ex. 3962P 04 D 1 X - A
- 04... Circuit no.
- A... High Current Type
- X... Plating Selection, V... Matte Tin

## P.C. Board Layout / Assembly Layout

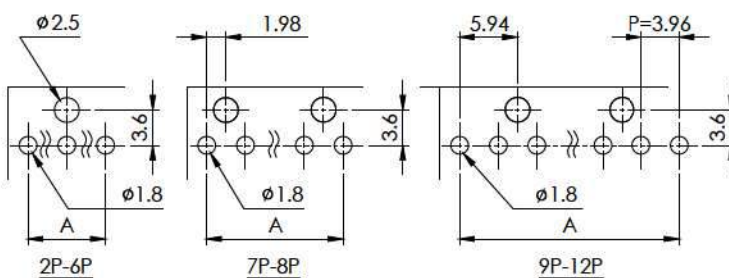

## Straight Type

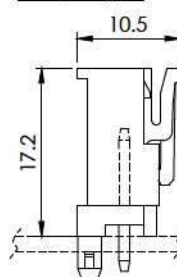

## Right-Angle Type

