

MATERIAL
 Panel: SPCC
 Plastic frame: ABS, UL94V-0
 Jack housing: PC, UL 94 V-0
 Jack contacts: C5210-EH phosphor bronze flat pin, T=0.35 mm, plated with 60 μ" thick nickel underplate
 IDC housing: PC, UL94V-0
 IDC terminals: C5191R-H phosphor bronze, t=0.4 mm, plated with 150μ" thick tin over 70 μ" thick nickel underplate
 RoHS 2 compliant

PHYSICAL CHARACTERISTICS
 Suitable impact tool: 110 style punch down tool
 Insertion life: 750 mating cycles with FCC compliant 8P plug
 Contact force: 100 grams with FCC compliant 8P plug
 Plug retention force: 11 lbf min
 Durability: 200 termination cycles
 Contact compatibility: accommodates 22 to 24 AWG solid
 Operating temperature range: -10°C to 60°C
 Storage temperature range: -40°C to 68°C
 Humidity: 10%-90%RH (non-condensing)

ELECTRICAL
 Insulation resistance: 500 MΩ min.
 Dielectric withstanding voltage: 1000 V AC
 DC current rating: 1.5 Amps
 DC resistance: 0.1 Ω max.
 Contact resistance: 20 mΩ max.

NOTE
 Only accept RJ-45 8P8C plug

ACCORDING TO
 ANSI/TIA-568.2-D
 ISO/IEC 11801
 IEC 60603-7



SUGGESTED CUTOUT: FLUSH-MOUNT APPLICATION

METAL

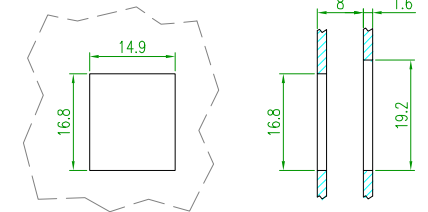

PLASTIC

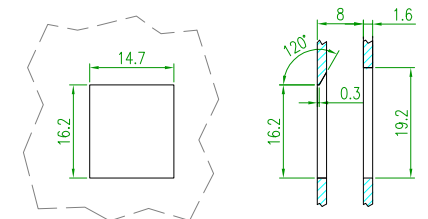

PIN ASSIGNMENTS

	T568B	T568A
1	WHITE/ORANGE	WHITE/GREEN
2	ORANGE	GREEN
3	WHITE/GREEN	WHITE/ORANGE
4	BLUE	BLUE
5	WHITE/BLUE	WHITE/BLUE
6	GREEN	ORANGE
7	WHITE/BROWN	WHITE/BROWN
8	BROWN	BROWN

DRAWN BY Vick Huang				
APPROVED BY Kevin Wu				
UNIT: mm [inch] TOLERANCES:				
-20	-50	-150	150-	ANGLE
±0.2	±0.4	±0.5	±1.5	±2°

HCI HSIUNG CHAU INDUSTRIAL CO., LTD.

PART NO. 3013AHQ5e VER. 1

CUSTOMER P/N. DATE 2020.09.09 SCALE X SHEET 1/1

2		
1		
REV.	DESCRIPTION	DATE

3rd Angle Projection

