



浙江津达电子有限公司

ZHEJIANG JINDA ELECTRONIC CO., LTD

客户名称 CUSTOMER					
客户料号 CUSTOMER P/N					
品名 PRODUCT NAME	63080				
编号 PRODUCT ID					
日期 APPROVAL DATE					
拟制 ORGANIZER		审核 AUDITOR		批准 APPROVAL	

承 认 书

SPECIFICATION FOR APPROVAL

客户承认 (CUSTOMER APPROVAL)		
工 程 ENGINEERING	品 管 Q. C	核 准 APPROVAL

厂址：中国·浙江省乐清市虹桥镇信岙工业区信达路 21 号

Add: No. 21 Xinda Road Xin' ao Industrial Park Hongqiao Town Yueqing City Zhejiang Province China

电话/Tel: +86-577-62322208

传真/Fax: +86-577-62311920

企业邮箱/E-mail: sales1@jdlh.com

网址/Http://www.jdlh.com

邮编/P. C: 325608

浙江津达电子有限公司 ZHEJIANG JINDA ELECTRONIC CO., LTD	产品类别 Product Class	条形连接器
	产品名称 Product Name	63080
产品承认书 SPECIFICATION FOR APPROVAL	产品编号 PRODUCT ID	
	/	/

目 录
CATALOG

一、封面 COVER	1
二、目录 CATALOG	2
三、技术规格 SPECIFICATIONS	3~7
四、产品图纸 DRAWING	8~13

新版发行 (2020. 08. 28)	A/0	WZY	ZAQ
更新内容	版本	修订	批准

浙江津达电子有限公司 ZHEJIANG JINDA ELECTRONIC CO., LTD	产品类别 Product Class	条形连接器
	产品名称 Product Name	63080
产品规格书 PRODUCT SPECIFICATION	产品编号 PRODUCT ID	
	页 码 Page Number	第 1 页/共 6 页

1. 构造: Construction
形状、尺寸依照附图规定
Shape and dimensions subject to attached chart regulation
2. 材料: Material
依照附图规定
Subject to attached chart regulation
3. 孔位: Poles
2~15
4. 适用线规: Applicable Wires
20~14AWG
5. 适用温度范围: Ambient temperature Range
-25°C~+85°C
6. 适用基板厚度: Applicable PC board thickness
0.8~1.6mm
7. 额定电压: Voltage rating
300V AC/DC
8. 额定电流: Current rating
13.0A AC/DC MAX.
9. 环保: Environmental protection
本产品符合 ROHS 环保要求
RoHS compliant and customer' s environment protection request compliant
10. 包装 Packaging
产品内包装为袋装, 外包装为纸箱, 产品在箱内密封, 不晃动
Unless otherwise specified, the series connectors are packed with Bag
11. 运输 Transportation
允许用任何方式运输, 但需避免雨雪淋和阳光照射, 不能有碰撞和挤压等机械损伤, 运输环境温度
温度为-20°C~+50°C
Any vehicle can be adopted for the transportation, but inoistre-proof and no mechanical damage, transport temperature to -20°C~+50°C
12. 贮存: Store up
包装完毕的连接器应在环境温度为-20°C~+50°C, 相对湿度不大于 80%, 周围空气中没有酸性、碱性及其它腐蚀性气体的仓库中贮存。
Temperature: -20°C~+50°C
Relative Humidity: <80%
No to storage in corrosive environments
13. 产品性能要求: Performance
产品规格书 2~5 页
Product specification 2~5 pages

浙江津达电子有限公司 ZHEJIANG JINDA ELECTRONIC CO., LTD		产品类别 Product Class	条形连接器	
		产品名称 Product Name	63080	
产 品 规 格 书 PRODUCT SPECIFICATION		产品编号 PRODUCT ID		
		页 码 Page Number	第 2 页/共 6 页	
序号	项目 Item	测试条件 Test Condition	规格要求 Requirement	
13.1	外观 Appearance	目测 Visual by eye 视力: 1.0 以上 Light: >1.0 照明: (200~300) lx Lamp: (200~300) lx 目测距离: (0.3~0.5) m Space: (0.3~0.5) m	1. 塑料件表面应无明显疤痕、杂色、开裂、毛刺、飞边、缺料及影响使用的变形 Plastic part: smooth and flat surface without discolor, broken, crack, distortion defects is acceptable 2. 金属件表面应光洁, 无锈蚀、氧化、脱皮、发黑及明显的机械损伤等缺陷 Metal part: bright and even surface without rust, oxide, fog and obvious physical damage defects is acceptable	
13.2	接触电阻 Contact Resistance	插配阴阳连接器后, 用小功率电阻测试仪进行测试 Mate connectors, measure by dry circuit	$\leq 20\text{m}\Omega$ (Initial)	
13.3	绝缘电阻 Insulation Resistance	插配阴阳连接器后, 在相邻接触件之间或地线之间, 用 500V DC 电压进行测试 Mate connectors, apply 500V DC between adjacent terminal or ground	$\geq 1000\text{M}\Omega$	
13.4	耐电压 Withstand voltage	相邻接触件之间或地线之间施加 50Hz 1500V AC (有效值), 漏电流 1mA 的电压作用, 时间 1 分钟. Mate connectors, apply 1500V AC for 1min between adjacent terminal or ground	无击穿和飞弧现象 No Breakdown	
13.5	插拔力 Insertion and Withdrawal Force	单 PIN 相配的接触件以 1mm/s~5mm/s 的速度沿连接器轴线方向插入和拔出 Insert and withdraw single contact at the speed rate of 1mm/s~5mm/s	插入力 (最大值) Insertion (MAX.) $\leq 50.0\text{N/PIN}$ (Solid PIN)	拔出力 (最小值) Withdrawal (MIN.) $\geq 8.0\text{N/PIN}$ (Solid PIN)
			插入力 (最大值) Insertion (MAX.) $\leq 20.0\text{N/PIN}$ (Stamping PIN)	拔出力 (最小值) Withdrawal (MIN.) $\geq 4.0\text{N/PIN}$ (Stamping PIN)

浙江津达电子有限公司
ZHEJIANG JINDA ELECTRONIC CO., LTD

产品类别
Product Class

条形连接器

产品名称
Product Name

63080

产品规格书
PRODUCT SPECIFICATION

产品编号
PRODUCT ID

页 码
Page Number

第 3 页/共 6 页

序号	项目 Item	测试条件 Test Condition	规格要求 Requirement	
13.6	端子在塑件中的保持力 Terminal/Housing Retention Force	固定连接器端在测力计上，在连接器轴线方向施加规定的拉力，速度不大于 25mm/分钟 Apply axial pull out force at the speed rate of not more 25mm/min on the pin assemble in the housing	≥30N	
13.7	压着部位的抗张强度 Crimping pull Out Force	在试验装置夹头中固定试验样品，在连接器的轴线方向施加张力；速度不大于 25mm/分钟 Fix the crimped terminal, apply axial pull out force on the wire at the speed rate of not more 25mm/min	14AWG ≥ 130N 16AWG ≥ 95N 18AWG ≥ 70N 20AWG ≥ 50N	
13.8	针固定力 Pin retentive Force	将针座放在插拔机上，以每分钟 25 ± 5mm 的速度垂直把针推出针座 Putting the wafer on the force tester and push the pins out vertically at the speed rate of 25 ± 5mm per minutes	≥15N	
13.9	耐高温 Heat Resistance	把试件放入高温试验箱中，以 (0.7~1) °C/min 的温度变化速度，将温度调到 (85 ± 2) °C。待平衡后保持 4h，然后以同样的速度降到室温，恢复 2h 检验 (85 ± 2) °C，4h	外观 Appearance	无损伤 No Damage
			接触电阻 Contact Resistance	≤30mΩ
13.10	耐寒性 Cold Resistance	把试件放入低温试验箱中，以 (0.7~1) °C/min 的温度变化速度，将温度调到 (-25 ± 2) °C。待平衡后保持 4h，然后以同样的速度升到室温，恢复 2h 检查 (-25 ± 2) °C，4h	外观 Appearance	无损伤 No Damage
			接触电阻 Contact Resistance	≤30mΩ

浙江津达电子有限公司 ZHEJIANG JINDA ELECTRONIC CO., LTD		产品类别 Product Class	条形连接器	
		产品名称 Product Name	63080	
产品规格书 PRODUCT SPECIFICATION		产品编号 PRODUCT ID		
		页 码 Page Number	第 4 页/共 6 页	
序号	项目 Item	测试条件 Test Condition	规格要求 Requirement	
13.11	温度循环 Temperature Cycling	把试验样品分别放入高、低温试验箱, 按下列步骤调试温度: a) 在 $(-25 \pm 2)^\circ\text{C}$ 的恒温条件下放置 2 小时; b) 在常温条件下放置 1 小时; c) 在 $(85 \pm 2)^\circ\text{C}$ 的恒温条件下放置 2 小时; d) 在常温条件下放置 1 小时 从 a) 到 d) 为一个循环周期, 共进行 5 个循环, 恢复 2 小时检查 5 cycles of: a) $(-25 \pm 2)^\circ\text{C}$ 2h b) $(85 \pm 2)^\circ\text{C}$ 2h	外观 Appearance	无损伤 No Damage
			接触电阻 Contact Resistance	$\leq 30\text{m}\Omega$
13.12	恒定湿热 Humidity	温度 $(40 \pm 2)^\circ\text{C}$, 相对湿度 $(90 \sim 95)\%$ 放置 96 小时, 取出恢复 2 小时后检查 Temperature $(40 \pm 2)^\circ\text{C}$ Relative Humidity: $(90 \sim 95)\%$ Duration 96h	外观 Appearance	无损伤 No Damage
			耐电压 Withstand voltage	1000V, AC/min
			绝缘电阻 Insulation Resistance	$\geq 500\text{M}\Omega$
13.13	耐振动性 Vibration Resistance	插入连接器, 串联在一直电流电源上, 电流 1mA; 并模拟正常工作状态, 振频为 $(10 \sim 55)\text{Hz}$ 、振幅 0.35mm; $(55 \sim 500)\text{Hz}$ 、加速度 50m/s^2 . 每一轴线扫频循环次数 10 次、历时 2 小时 Amplitude: $\pm 0.35\text{mm}$ Frequency: $(10 \sim 55)\text{Hz}$ Frequency: $(>55 \sim 500)\text{Hz}$ Acceleration: 50m/s^2 Duration: 2h in each X、Y、Z axes	外观 Appearance	无损伤 No Damage
			接触电阻 Contact Resistance	$\leq 30\text{m}\Omega$
			瞬断 Discontinuity	$\leq 1\ \mu\text{S}$

浙江津达电子有限公司 ZHEJIANG JINDA ELECTRONIC CO., LTD			产品类别 Product Class	条形连接器
			产品名称 Product Name	63080
产品规格书 PRODUCT SPECIFICATION			产品编号 PRODUCT ID	
			页 码 Page Number	第 5 页/共 6 页
序号	项目 Item	测试条件 Test Condition	规格要求 Requirement	
13.14	机械寿命 Repeated Insertion/ withdrawal	无通电状态下, 10 次/分钟的速度插拔 50 次 When mated up to 50 cycles repeatedly by the rate of 10 cycles per minute	接触电阻 Contact Resistance	$\leq 30\text{m}\Omega$
13.15	盐雾测试 Salt Spray Test	把试验样品从试验箱顶悬挂下来, 采用浓度为 $(5\pm 1)\%$ 的氯化钠溶液, 连续雾化 16h, 试验后用流动的蒸馏水轻轻洗去表面沉淀积物。在常温条件下恢复 1~2 小时。 16 h exposure to a salt spray from the $(5\pm 1)\%$ solution	外观 Appearance	无损伤、腐蚀（五金件应无露出底金属的严重锈蚀；使用预镀好的型材，其落料面允许有不影响其性能的轻微腐蚀。） No Damage
13.16	可焊性 Solder ability	把试验样品需要焊接的部位浸入 $235\pm 5^\circ\text{C}$ 的锡槽中：历时 $3\pm 0.5\text{sec}$ Soldering Time: $3\pm 0.5\text{ sec}$ Soldering Temperature: $235\pm 5^\circ\text{C}$	沾敷性 Solder wetting	沾敷面积 95%以上
13.17	耐焊接热 Resistance to Soldering heat	把试验样品需要焊接的部分浸入 $260\pm 5^\circ\text{C}$ 的锡炉中：历时 $3\pm 1\text{sec}$ Soldering Time: $3\pm 1\text{sec}$ Soldering Temperature: $260\pm 5^\circ\text{C}$	外观 Appearance	无损坏，变形 No Damage
13.18	温度上升 Temperature Rise	插合连接器，通以最大容许电流 Carrying rated current load	温度上升 Temperature Rise	$\leq 30^\circ\text{C}$

Note: 若本规格书中的要求与产品图纸发生冲突，则产品图中的要求为优先；若本规格书中的要求与其他参考文件中的要求冲突，则本规格书为优先。

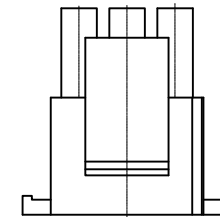
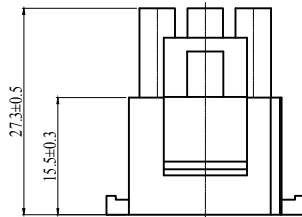
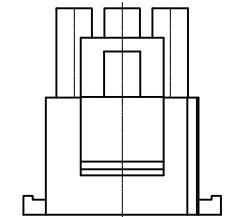
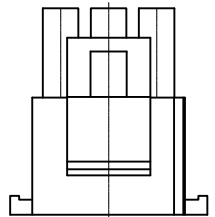
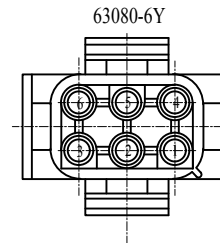
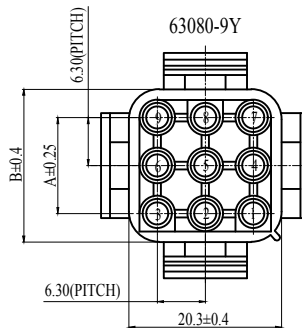
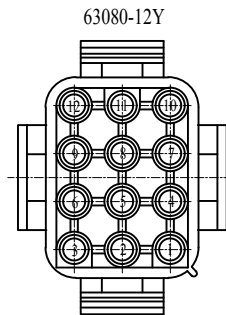
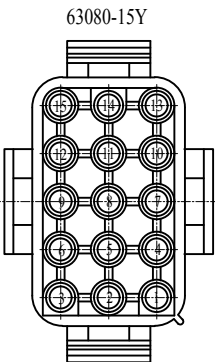
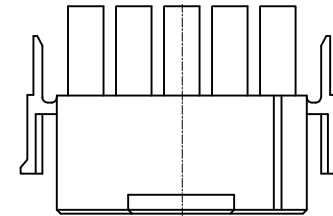
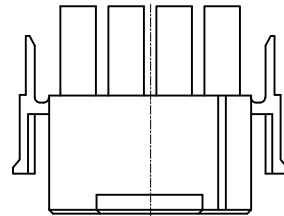
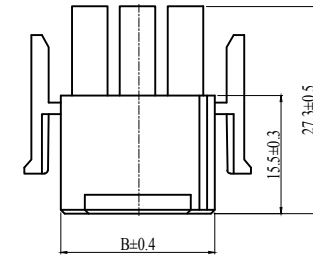
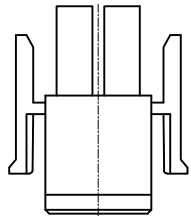
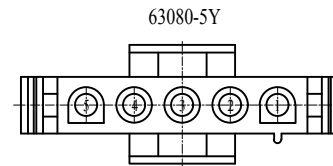
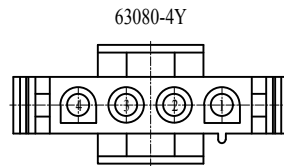
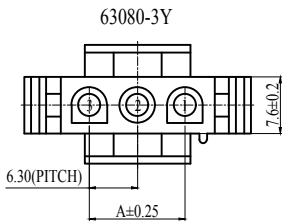
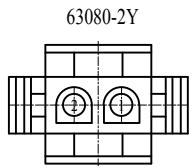

REVISIONS				
P	LTR	DESCRIPTION	DATE	APVD

■ 技术参数 (SPECIFICATIONS)

- ◆ 额定电压: 300V AC DC
Voltage rating: 300V AC DC
- ◆ 额定电流: 13.0A AC DC MAX.
Current rating: 13.0A AC DC MAX.
- ◆ 耐压值: 1500V AC/minute
Withstand voltage: 1500V AC/minute
- ◆ 绝缘电阻: 1000MΩ MIN
Insulation resistance: 1000MΩ MIN
- ◆ 接触电阻: 20mΩ MAX(初始值)
Contact resistance: 20mΩ MAX(Initial)
- ◆ 工作温度: -25°C~+85°C
Working Temperature: -25°C~+85°C
- ◆ 适用线规: 20~14AWG
Applicable Wire: 20~14AWG
- ◆ 间距: 6.3 mm
Pitch: 6.3 mm

■ 材料 (MATERIAL)

- ◆ 外壳: 尼龙66 透明
Housing: PA66 Transparent

POLES	P/N	A	B
2	63080-2Y	6.3	14.0
3	63080-3Y	12.6	20.3
4	63080-4Y	18.9	26.6
5	63080-5Y	25.2	32.9
6	63080-6Y	6.3	14.0
9	63080-9Y	12.6	20.3
12	63080-12Y	18.9	26.6
15	63080-15Y	25.2	32.9

JINDA®
ZheJiang JinDa Electric Co. Ltd.
浙江津达电子有限公司

GENERAL TOLERANCE	
XX. ±0.40	XXX. ±0.50
X. ±0.30	.XXX ±0.10
.X ±0.25	X° ±2°
.XX ±0.15	.X° ±1°

SCALE:	DRAWING: WZY
UNIT: mm	CHECK:
SIZE: A4	APPROVE:

DATE: 2020.08.26	PRODUCT NAME: 63080-nY
DATE:	PRODUCT ID:
DATE:	

TITLT. 成品图	REV. A
	SHEET. 1/1

REVISIONS				
P	LTR	DESCRIPTION	DATE	APVD

- 技术参数 (SPECIFICATIONS)
- ◆ 额定电压: 300V AC DC
Voltage rating: 300V AC DC
 - ◆ 额定电流: 13.0A AC DC MAX.
Current rating: 13.0A AC DC MAX.
 - ◆ 耐压值: 1500V AC/minute
Withstand voltage: 1500V AC/minute
 - ◆ 绝缘电阻: 1000MΩ MIN
Insulation resistance: 1000MΩ MIN
 - ◆ 接触电阻: 20mΩ MAX(初始值)
Contact resistance: 20mΩ MAX(Initial)
 - ◆ 工作温度: -25°C~+85°C
Working Temperature: -25°C~+85°C
 - ◆ 适用线规: 20~14AWG
Applicable Wire: 20~14AWG
 - ◆ 间距: 6.3 mm
Pitch: 6.3 mm

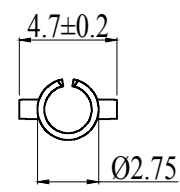
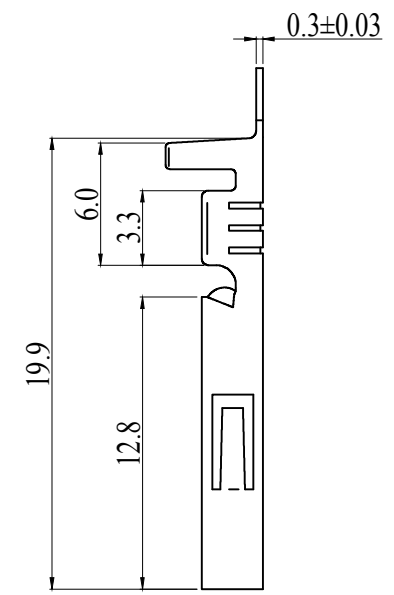
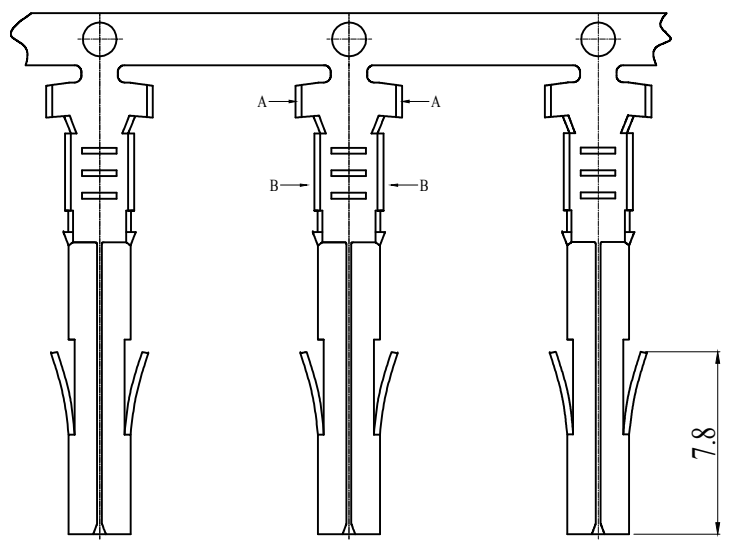
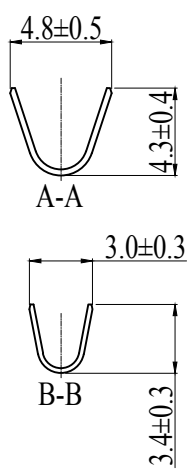

PRODUCT ID	PRODUCT NAME	MATERIAL	FINISH	AWG	Q'ty/reel
	63080-T	Phosphor Bronze	TIN	20~14	4500pcs

 ZheJiang JinDa Electric Co. Ltd. 浙江津达电子有限公司	GENERAL TOLERANCE		SCALE:	DRAWING: WZY	DATE: 2020.08.26	PRODUCT NAME: 63080-T	TITLT. 成品图	REV.
	XX. ±0.40	XXX. ±0.50	UNIT: mm	CHECK:	DATE:			A
	X. ±0.30	.XXX ±0.10	SIZE: A4	APPROVE:	DATE:	PRODUCT ID:	SHEET.	
	.X ±0.25	X° ±2°	④				1/1	
.XX ±0.15	.X° ±1°							

A

B

C

D

E

REVISIONS				
P	LTR	DESCRIPTION	DATE	APVD

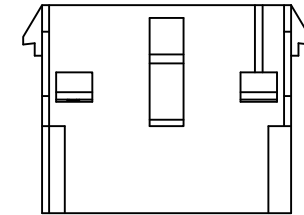
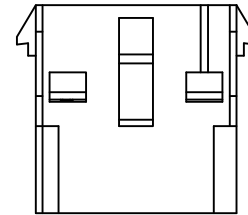
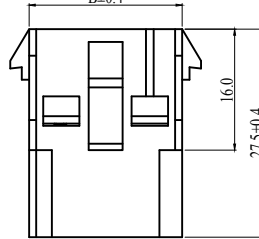
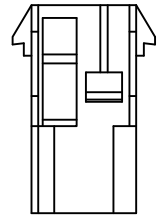
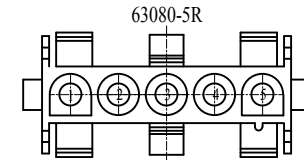
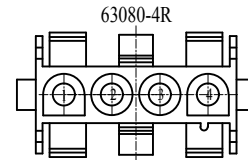
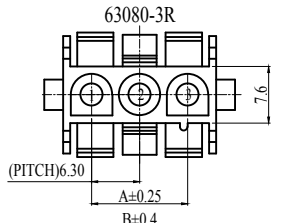
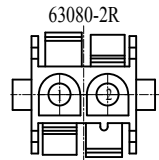

■ 技术参数 (SPECIFICATIONS)

- ◆ 额定电压: 300V AC DC
Voltage rating: 300V AC DC
- ◆ 额定电流: 13.0A AC DC MAX.
Current rating: 13.0A AC DC MAX.
- ◆ 耐压值: 1500V AC/minute
Withstand voltage: 1500V AC/minute
- ◆ 绝缘电阻: 1000MΩ MIN
Insulation resistance: 1000MΩ MIN
- ◆ 接触电阻: 20mΩ MAX(初始值)
Contact resistance: 20mΩ MAX(Initial)
- ◆ 工作温度: -25°C~+85°C
Working Temperature: -25°C~+85°C
- ◆ 适用线规: 20~14AWG
Applicable Wire: 20~14AWG
- ◆ 间距: 6.3 mm
Pitch: 6.3 mm

■ 材料 (MATERIAL)

- ◆ 外壳: 尼龙66 透明
Housing: PA66 Transparent

63080-15R

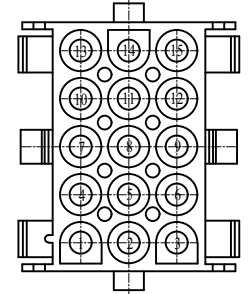

63080-12R

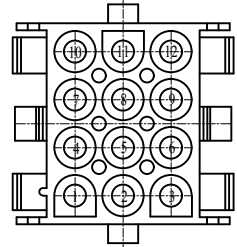

63080-9R

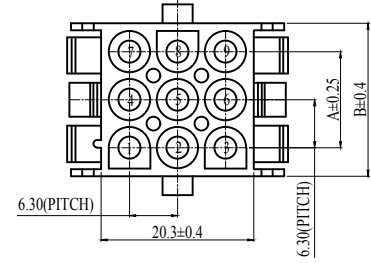

63080-6R

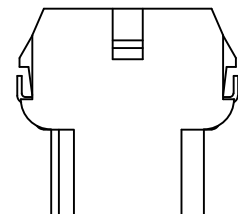
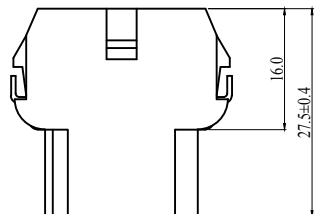
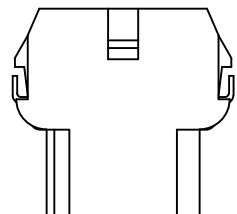
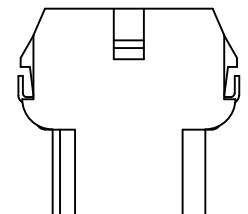
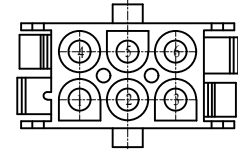

POLES	P/N	A	B
2	63080-2R	6.3	14.0
3	63080-3R	12.6	20.3
4	63080-4R	18.9	26.6
5	63080-5R	25.2	32.9
6	63080-6R	6.3	14.0
9	63080-9R	12.6	20.3
12	63080-12R	18.9	26.6
15	63080-15R	25.2	32.9



ZheJiang JinDa Electric Co. Ltd.
浙江津达电子有限公司

GENERAL TOLERANCE	
XX. ±0.40	XXX. ±0.50
X. ±0.30	.XXX ±0.10
.X ±0.25	X° ±2°
.XX ±0.15	.X° ±1°

SCALE:	DRAWING: WZY	DATE: 2020.08.27
UNIT: mm	CHECK:	DATE:
SIZE: A4	APPROVE:	DATE:

PRODUCT NAME:	63080-nR
PRODUCT ID:	

TITLT.	成品图
--------	-----

REV.	A
SHEET.	1/1

A

B

C

D

E

REVISIONS					
P	LTR	DESCRIPTION	DATE	DWN	APVD

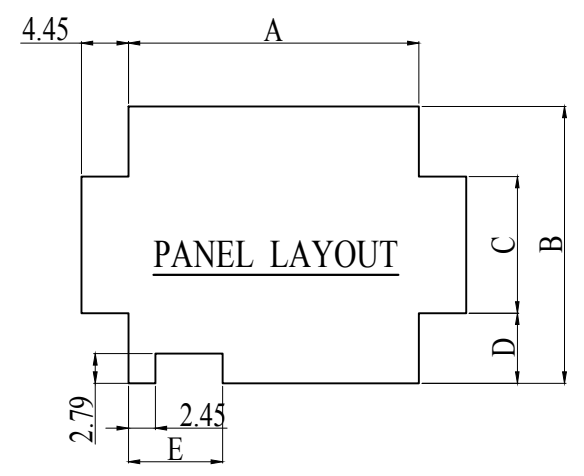
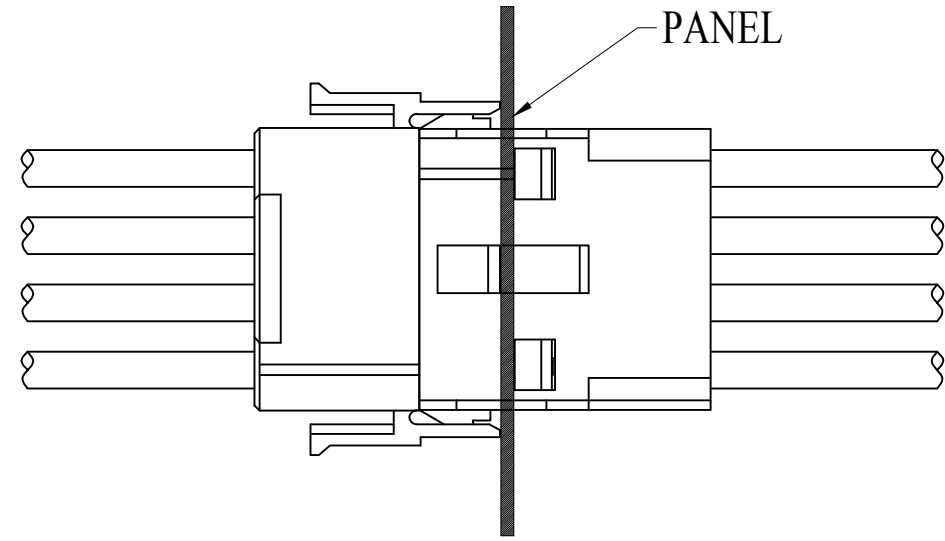

POLES	A	B	C	D	E
2	14.35	13.46	8.64	2.41	6.35
3	20.7	13.46	8.64	2.41	6.35
4	27.05	13.46	8.64	2.41	6.35
5	33.4	13.46	8.64	2.41	6.35
6	14.45	26.16	12.9	6.99	6.35
9	20.9	26.16	12.9	6.99	6.35
12	27.45	26.16	12.9	6.99	8.89
15	33.5	26.16	12.9	6.99	8.89



 ZheJiang JinDa Electric Co. Ltd.

 浙江津达电子有限公司

GENERAL TOLERANCE	
XX. ±0.40	XXX. ±0.50
X. ±0.30	.XXX ±0.10
.X ±0.25	X° ±2°
.XX ±0.15	.X° ±1°

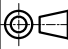
SCALE:	UNIT: mm
SIZE: A4	

DRAWING: WZY	CHECK:	APPROVE:
--------------	--------	----------

DATE: 2020.08.27	DATE:	DATE:
------------------	-------	-------

PRODUCT NAME: 63080系列面板安装	PRODUCT ID:
------------------------------	-------------

TITLT. 成品图

REV. A
SHEET. 1/1

REVISIONS					
P	LTR	DESCRIPTION	DATE	DWN	APVD

- 技术参数 (SPECIFICATIONS)
- ◆ 额定电压: 300V AC DC
Voltage rating: 300V AC DC
 - ◆ 额定电流: 13.0A AC DC MAX.
Current rating: 13.0A AC DC MAX.
 - ◆ 耐压值: 1500V AC/minute
Withstand voltage: 1500V AC/minute
 - ◆ 绝缘电阻: 1000MΩ MIN
Insulation resistance: 1000MΩ MIN
 - ◆ 接触电阻: 20mΩ MAX(初始值)
Contact resistance: 20mΩ MAX(Initial)
 - ◆ 工作温度: -25°C~+85°C
Working Temperature: -25°C~+85°C
 - ◆ 适用线规: 20~14AWG
Applicable Wire: 20~14AWG
 - ◆ 间距: 6.3 mm
Pitch: 6.3 mm

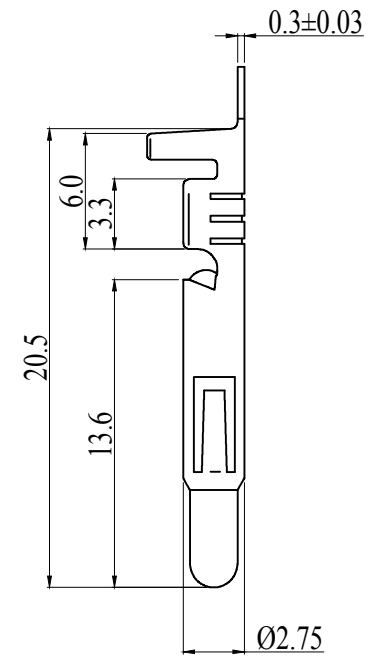
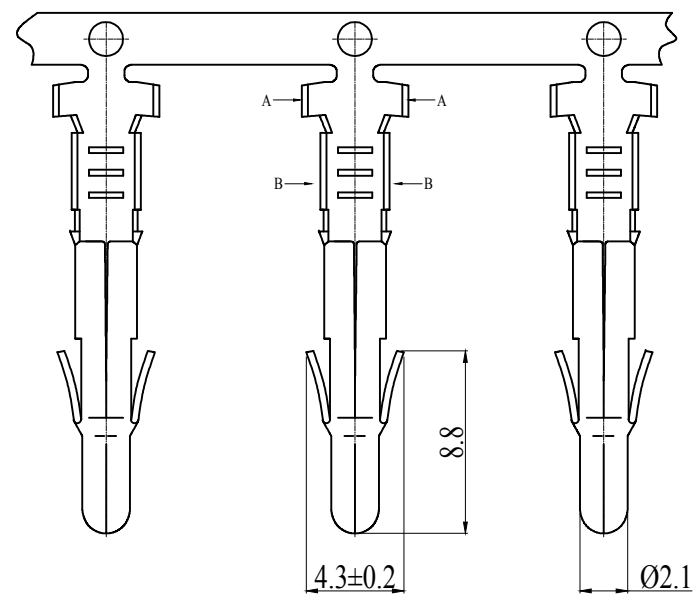
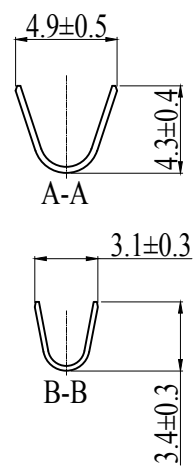

PRODUCT ID	PRODUCT NAME	MATERIAL	FINISH	AWG	Q'ty/reel
	63080-RT	Phosphor Bronze	TIN	20 ~ 14	4500pcs

JINDA®
ZheJiang JinDa Electric Co. Ltd.
浙江津达电子有限公司

GENERAL TOLERANCE	
XX. ±0.40	XXX. ±0.50
X. ±0.30	.XXX ±0.10
.X ±0.25	X° ±2°
.XX ±0.15	.X° ±1°

SCALE:	UNIT: mm
SIZE: A4	APPROVE:

DRAWING: WZY
CHECK:
DATE: 2020.08.27

DATE:
DATE:

PRODUCT NAME:
63080-RT
PRODUCT ID:

TITLT.
成品图

REV. A
SHEET. 1/1

REVISIONS				
P	LTR	DESCRIPTION	DATE	APVD

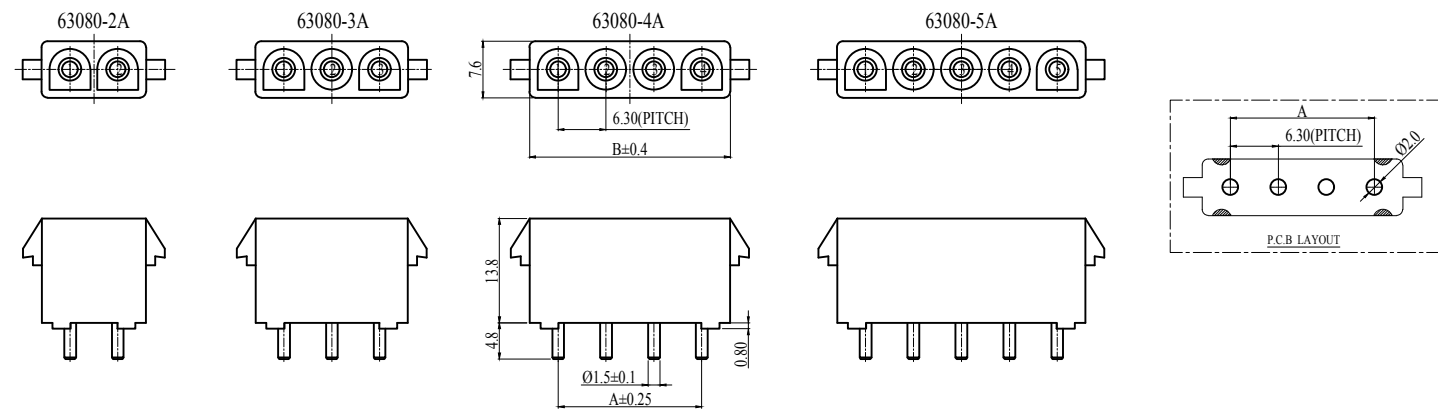

- 技术参数 (SPECIFICATIONS)
- ◆ 额定电压: 300V AC DC
Voltage rating: 300V AC DC
 - ◆ 额定电流: 13.0A AC DC MAX.
Current rating: 13.0A AC DC MAX.
 - ◆ 耐压值: 1500V AC/minute
Withstand voltage: 1500V AC/minute
 - ◆ 绝缘电阻: 1000MΩ MIN
Insulation resistance: 1000MΩ MIN
 - ◆ 接触电阻: 20mΩ MAX(初始值)
Contact resistance: 20mΩ MAX(Initial)
 - ◆ 工作温度: -25°C~+85°C
Working Temperature: -25°C~+85°C
 - ◆ 间距: 6.3 mm
Pitch: 6.3 mm
- 材料 (MATERIAL)
- ◆ 外壳: 尼龙66 透明
Housing: PA66 Transparent
 - ◆ 接触针: 黄铜镀锡
Contact PIN: Brass TIN-Plating

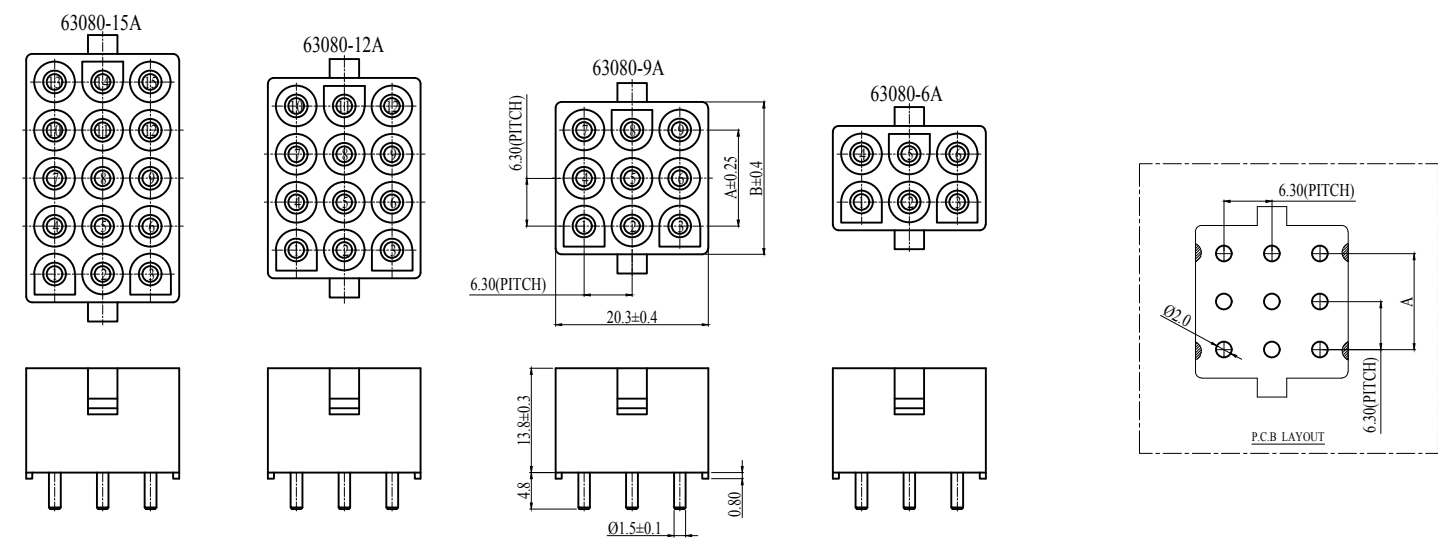

POLES	P/N	A	B
2	63080-2A	6.3	14.0
3	63080-3A	12.6	20.3
4	63080-4A	18.9	26.6
5	63080-5A	25.2	32.9
6	63080-6A	6.3	14.0
9	63080-9A	12.6	20.3
12	63080-12A	18.9	26.6
15	63080-15A	25.2	32.9

 ZheJiang JinDa Electric Co. Ltd. 浙江津达电子有限公司	GENERAL TOLERANCE		SCALE:	DRAWING: WZY	DATE: 2020.08.28	PRODUCT NAME: 63080-nA	TITLT. 成品图	REV. A
	XX. ±0.40	XXX. ±0.50	UNIT: mm	CHECK:	DATE:	PRODUCT ID:		SHEET. 1/1
	X. ±0.30	.XXX ±0.10	SIZE: A4	APPROVE:	DATE:			
	.X ±0.25	X° ±2°						
	XX ±0.15	X° ±1°						